



Elo Touch Solutions, Inc.
670N. McCarthy Blvd. Suite 100
Milpitas, CA 95035

EU Importer: Elo Touch Solutions, Inc.

EU Contact : Elo Touch Solutions

NV Winggepark5B/301 3110 Rotselaar, Belgium

Brand name : Elo

CAN ICES-3(B)/NMB-3(B)

This device complies with Part 15 of the FCC Rules.

Operation is subject to the following two conditions:

- (1) This device may not cause harmful interference, and
- (2) This device must accept any interference received including interference that may cause undesired operation.



4 Unit Device Charger only used with ELO TOUCH SOLUTIONS, INC.

Model: EMC-M100 or EMC-M100C.



Contents:

- 1 x 4 Unit Device Charger
- 4 x Spacer for Use without Rugged Case
- 1 x 120W Adapter
- 1 x Pan Head Screw: M3 x 10mm long
- 1 x AC Power Cable (US)
- 1 x AC Power Cable (EU)
- 1 x AC Power Cable (UK)

Learn more about Elo at [EloTouch.com](https://www.elotouch.com)

America

Tel +1 408 597 8000
EloSales.NA@elotouch.com

Europe (EMEA)

Tel +32 16 930 136
EMEA.sales@elotouch.com

Asia Pacific

Tel +86 (21) 3329 1385
EloAsia@elotouch.com

The information in this document is subject to change without notice. Elo Touch Solutions, Inc. and its Affiliates (collectively "Elo") makes no representations or warranties with respect to the contents herein, and specifically disclaims any implied warranties of merchantability or fitness for a particular purpose. Elo reserves the right to revise this publication and to make changes from time to time in the content hereof without obligation of Elo to notify any person of such revisions or changes.

No part of this publication may be reproduced, transmitted, transcribed, stored in a retrieval system, or translated into any language or computer language, in any form or by any means, including, but not limited to, electronic, magnetic, optical, chemical, manual, or otherwise without prior written permission of Elo Touch Solutions, Inc.

Elo and the Elo logo are either trademarks or registered trademarks of Elo Touch Solutions, Inc.

© 2024 Elo Touch Solutions, Inc. All rights reserved.



Quick Installation Guide

Elo Pay M100
4 Unit Device Charger

Revision A
P/N QIG600262



[www.EloTouch.com](https://www.elotouch.com)

This equipment has been tested and found to comply with the limits for a Class B digital device, pursuant to Part 15 of the FCC Rules. These limits are designed to provide reasonable protection against harmful interference in a residential installation. This equipment generates uses and can radiate radio frequency energy and, if not installed and used in accordance with the instructions, may cause harmful interference to radio communications. However, there is no guarantee that interference will not occur in a particular installation. If this equipment does cause harmful interference to radio or television reception, which can be determined by turning the equipment off and on, the user is encouraged to try to correct the interference by one of the following measures:

- Reorient or relocate the receiving antenna.
- Increase the separation between the equipment and receiver.
- Connect the equipment into an outlet on a circuit different from that to which the receiver is connected.
- Consult the dealer or an experienced radio/TV technician for help.

“Changes or modifications not expressly approved by the party responsible for compliance could void the user's authority to operate the equipment” .

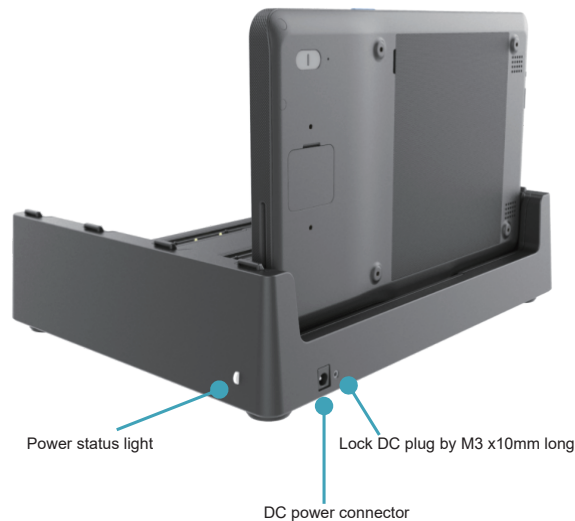

Spacer for Elo Pay M100 without rugged case.
To remove it: pinch tabs on both sides and lift out.

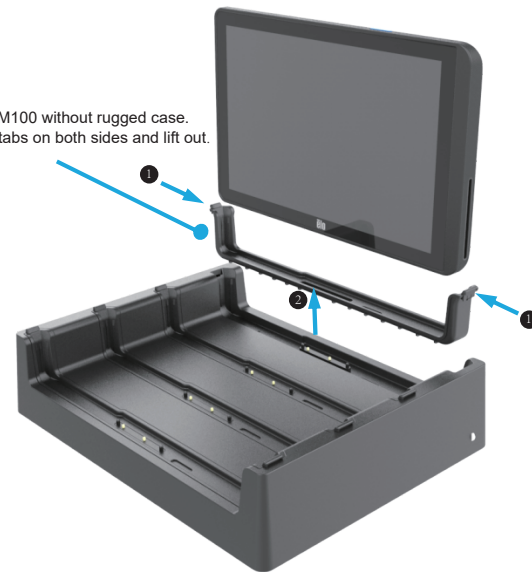

- 1 Push on the top on the spacer right and left.
- 2 Pull the spacer up from the left and right.