

Kit Contents

I-Series 5 Slate Display
I/O Hub
1.8m US Power Cable
1.8m EU Power Cable
DC Power Supply
VESA mount screws, M4x6mm (4)



Quick Installation Guide

I-Series 5 Slate



EU Battery Declaration

This symbol on the battery or on the packaging indicates that the battery provided with this product should not be treated as household waste. Instead, please separate the battery/batteries from other types of waste and recycle them through your local recycling system to protect the environment and health. The chemical symbol for lead (Pb) is added under this symbol if the battery contains more than 0.004% lead. Additionally, the chemical symbol for cadmium (Cd) is added under this symbol if the battery contains more than 0.002% cadmium. For more detailed information about the recycling of these batteries, please contact your local authority or the shop where you purchased the product or batteries.

Revision C
P/N E978896

Learn more about Elo at [EloTouch.com](https://www.elotouch.com)

America

Tel +1 408 597 8000
EloSales.NA@elotouch.com

Europe (EMEA)

Tel +32 16 930 136
EMEA.sales@elotouch.com

Asia Pacific

Tel +86 (21) 3329 1385
EloAsia@elotouch.com

The information in this document is subject to change without notice. Elo Touch Solutions, Inc. and its Affiliates (collectively "Elo") makes no representations or warranties with respect to the contents herein, and specifically disclaims any implied warranties of merchantability or fitness for a particular purpose. Elo reserves the right to revise this publication and to make changes from time to time in the content hereof without obligation of Elo to notify any person of such revisions or changes.

No part of this publication may be reproduced, transmitted, transcribed, stored in a retrieval system, or translated into any language or computer language, in any form or by any means, including, but not limited to, electronic, magnetic, optical, chemical, manual, or otherwise without prior written permission of Elo Touch Solutions, Inc.

Elo and the Elo logo are either trademarks or registered trademarks of Elo Touch Solutions, Inc.



- 1 Remove the cable locking screw and bracket from the rear of the I-Series 5 Slate display to access the USB-C connection.

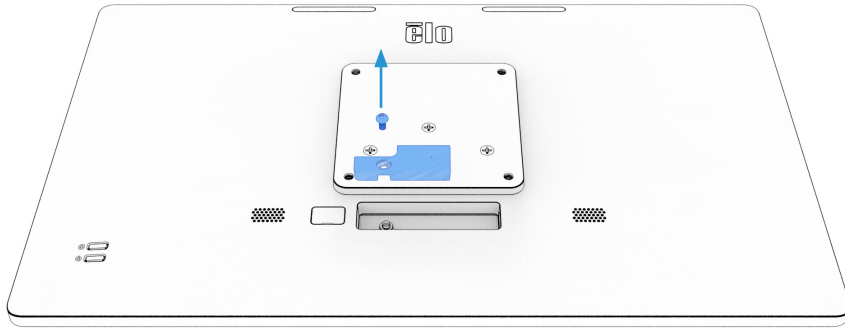

- 3 Reinstall the cable locking screw and bracket on the rear of the I-Series 5 Slate display. The bracket slides in at an angle and has two small hooks that engage with slots inside the cable cavity. The bracket must be secured with the included screw.

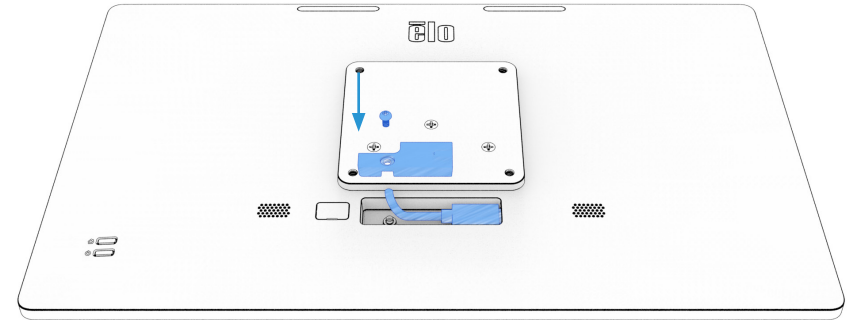

- 2 Plug the USB-C cable from the I/O hub to the rear of the I-Series 5 Slate display. The I/O hub has two threaded mounting holes which allow it to be mounted out of site if desired. See dimensional drawing for mounting hole details.

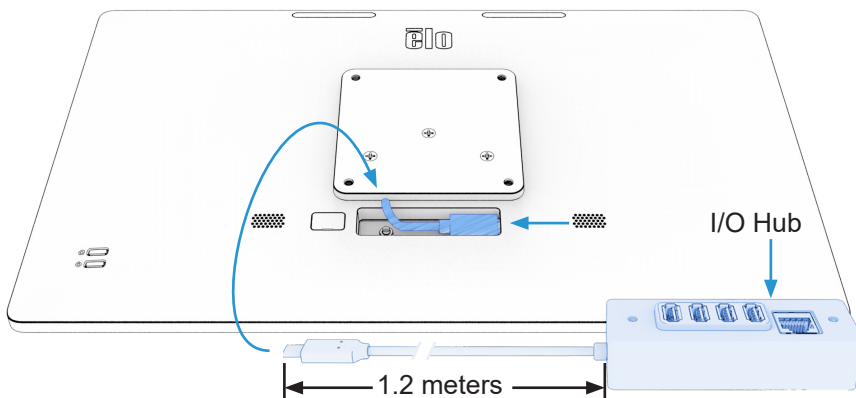

- 4 See detailed user guide at www.elotouch.com for additional information on mounting Elo I-Series 5 Slate display to Elo stands or wallmounts.

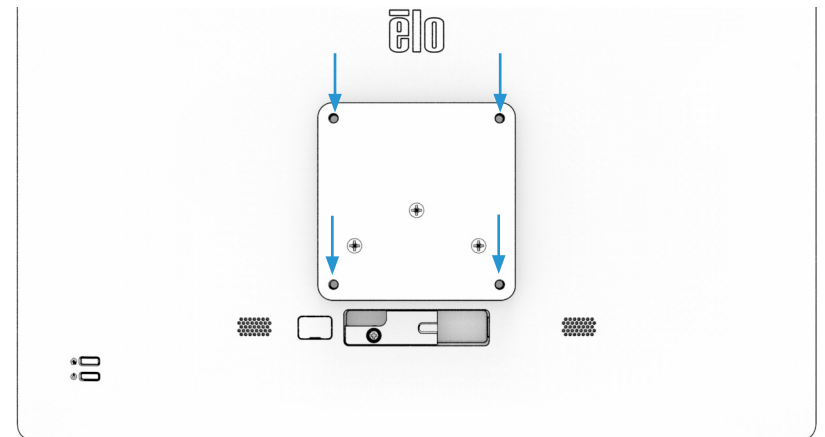



Quick Installation Guide

Z10 POS Stand (Gen2)

Revision A

P/N E661191

www.elotouch.com



Z10 POS Stand (Gen2)

Box Contents

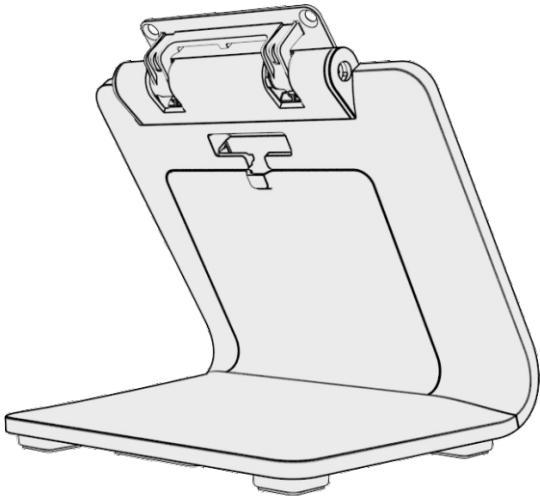

Z10 POS Stand (Gen2)

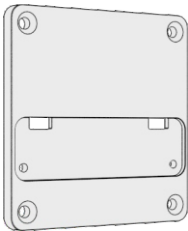

75x75mm VESA Adapter
Qty.1

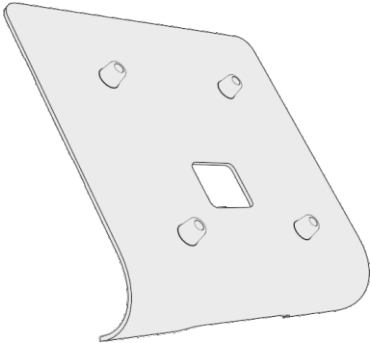

CFD Cover
Qty.1



M4x5, Flat-HEAD, SCREW
Qty. 2, Bag "A"



M4x10, Flat-HEAD, SCREW
Qty. 4, Bag "B"



M4x18, Flat-HEAD, SCREW
Qty. 4, Bag "C"

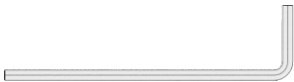

Hex 4x108 allen wrench, Qty.1

Preparing the Stand and Display

Step 1:

Prepare the Z10 Stand. The position of the hinge should be tilted to the rear limit. Rotate the hinge backwards if it is not in this position.

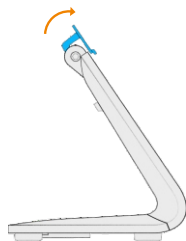

Step 2:

Prepare the display. For displays that ship with a VESA bracket installed on the back of the display, please remove it prior to installation on the Z10 Stand. Elo suggests storing the VESA bracket for future installation on a VESA-type stand. For displays without a VESA bracket, skip to **step 5**.

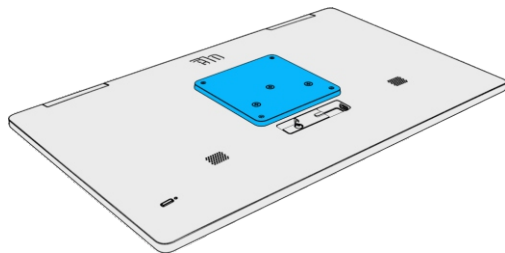

Step 3:

Disassemble the three screws as indicated and remove this part.

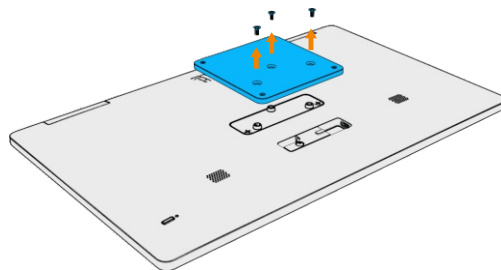

Step 4:

Continue to disassemble the two screws as indicated and remove this part.

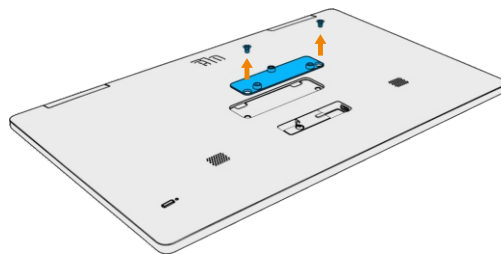

Installing a Display with 75x75mm VESA pattern

Step 5:

If installing a display with 75x75mm VESA pattern, you must first attach the VESA adapter to the display. If installing a display with Z-hinge pocket, skip to **step 7**.

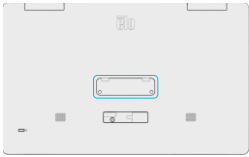

Z-hinge VESA Display

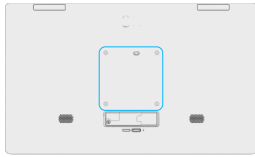

75x75mm VESA Display



75x75mm Z-hinge
VESA adapter

Step 6:

Attach the VESA adapter using four screws from bag "B" as shown. Note the orientation of the adapter (the adapter should not cover the cable area). The VESA adapter can now accept the Z10 Stand hinge. Proceed to **step 7**.

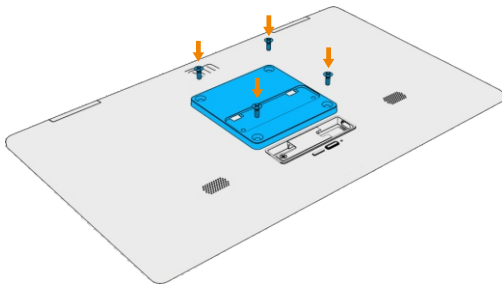

Installing a Display (with Z-Hinge)

Step 7:

Insert the two tabs of the hinge into the two slots in the mounting area of the Z-hinge pocket and tilt the display so that the hinge sits flush with the back cover.

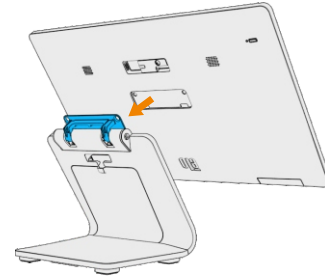

Step 8:

Fasten the display using two screws from bag "A". Complete the assembly and rotate the display as shown.

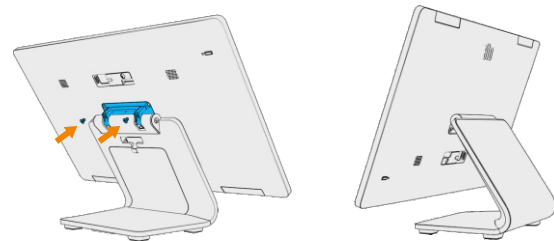

Hinge Torque Adjustment (Optional)

Z10 Stand has a torque adjustment function. The torque can be adjusted to support heavier or lighter displays. It is suggested not to adjust more than $\frac{1}{4}$ turn.

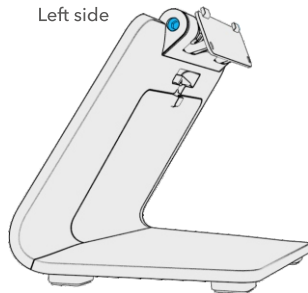

If needed, use the included Allen wrench to adjust the torque. Starting on the right side, turn the wrench clockwise to increase torque, and counter-clockwise to decrease torque.

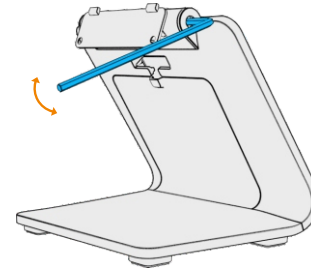

Repeat on the left side, turning the wrench clockwise to increase torque, and counter-clockwise to decrease torque. Make sure to adjust both sides equally.

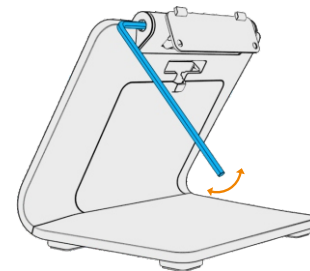

Cable Management

Step 1:

Rotate the display to ease the cable assembly. Remove the cable cover on the display and cable cover door on the stand.

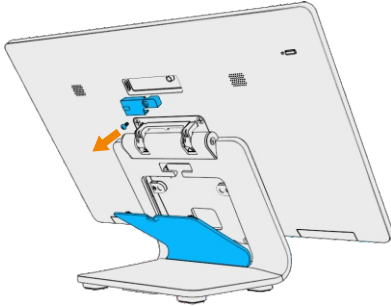

Step 2:

Connect type-C cable to the display and manage the cable as shown.

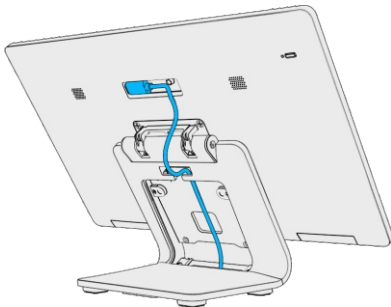

Step 3:

Assemble back the cable cover and cable cover door.

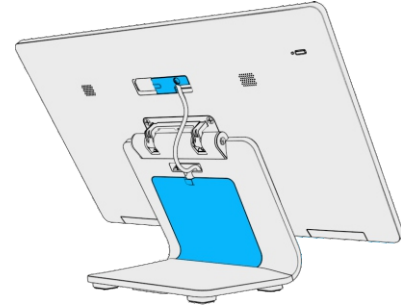

Step 4:

Complete the assembly and rotate the display as shown.

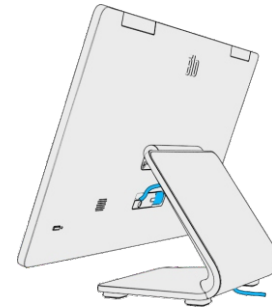

Customer-facing Display (CFD) Installation

Note: I/O Hub (sold separately, Elo P/N E955492) is required for connecting a CFD.

Step 1:

Remove the cable cover door from stand.

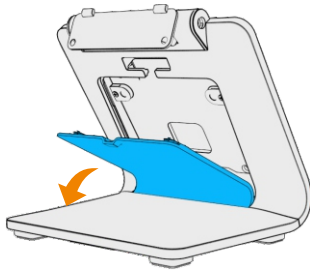

STEP 2:

Remove two screws.

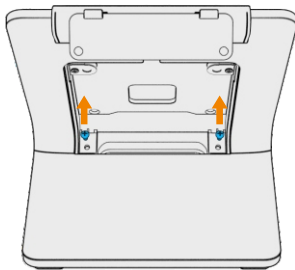

Step 3:

Slide the back cover down and remove from the stand.

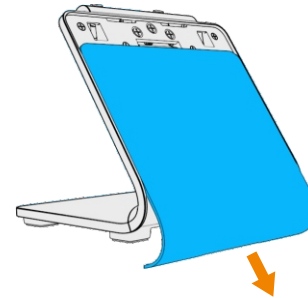

Step 4:

Slide the CFD cover up to assemble to the stand. Reinstall the two screws removed in step 2.

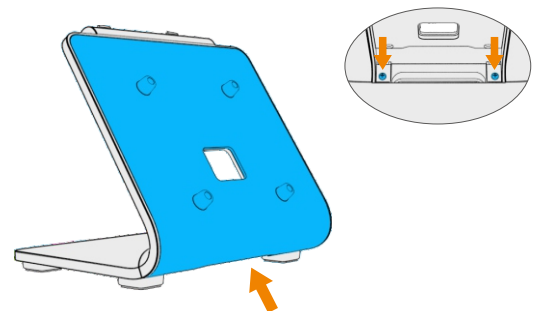

Step 5:

Connect the I/O Hub to the main display, routing the cable as shown (see display user manual for details on how to connect the cable to the display).

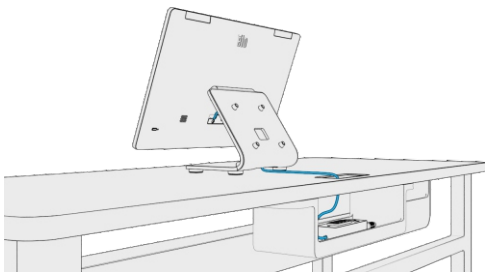

Step 6:

Connect the CFD to the I/O Hub using the cable included with the CFD, routing the cable as shown through the hole in the CFD cover (see CFD user manual for details on how to connect the cable to the CFD).

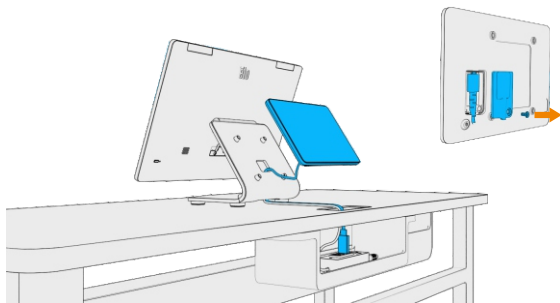

Step 7:

Fasten the CFD to the stand using four screws from bag "C" as shown.

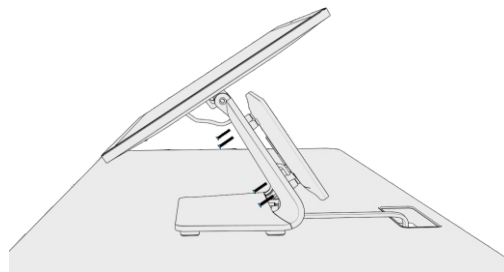

Step 8:

Reassemble the cable cover door and complete the installation.

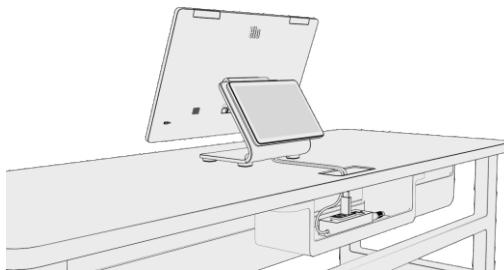

Attaching the Stand to a Countertop

Step 1:

Remove cable cover door from stand.

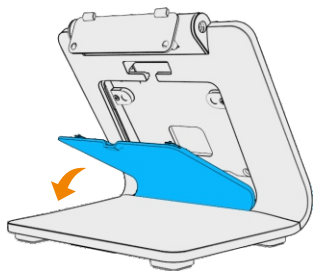

Step 2:

Use the included Allen wrench to press the hook on one side of the cover as shown, and slide the cover forward slightly.

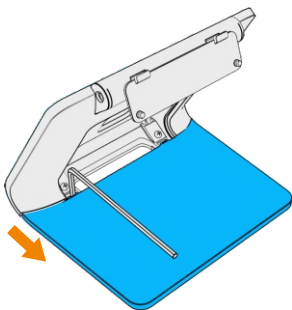

Step 3:

Use the same method to release the other side.

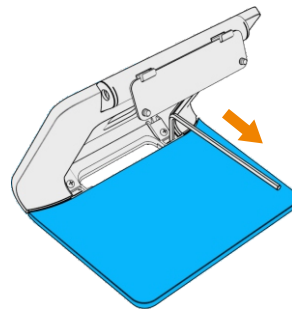

Step 4:

Slide the cover forward fully to remove from the stand.

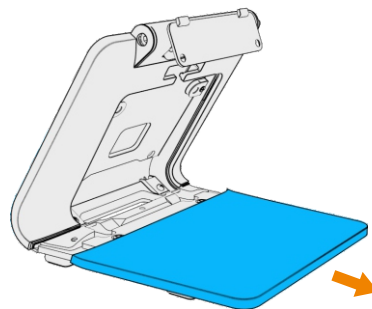

Step 5:

Attach the stand to the countertop through the two holes as indicated. Screws are not included, and should be chosen based on the countertop material. Suggested screw size is M4 or #8 (not to exceed 4.2mm in diameter).

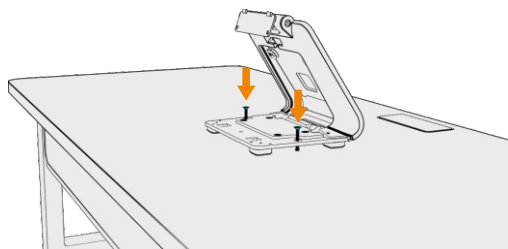

Step 6:

Reassemble the cover by sliding back until the hooks click into place.

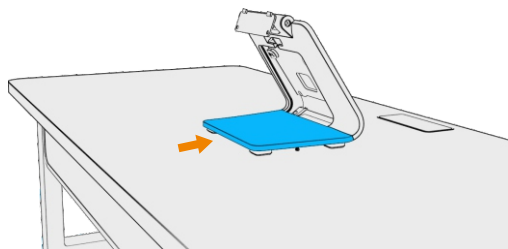

Step 7:

Reassemble the cable cover door.

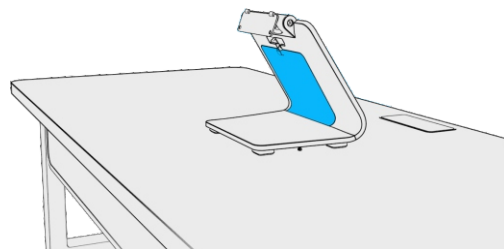

Step 8:

The stand is fastened to the countertop and assembly is complete.

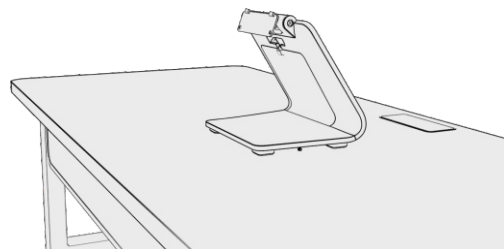

Full View After Setup



Elo Technical Support

Online self-help: www.elotouch.com/support

America

800-ELO-TOUCH

Tel +1 408 597 8000

EloSales.NA@elotouch.com

Asia-Pacific

Tel +86 (21) 3329 1385

EloAsia@elotouch.com

Europe(EMEA)

Tel +32 (0)16 930 136

EMEA.Sales@elotouch.com

The information in this document is subject to change without notice. Elo Touch Solutions, Inc. and its Affiliates (collectively “Elo”) makes no representations or warranties with respect to the contents herein, and specifically disclaims any implied warranties of merchantability or fitness for a particular purpose. Elo reserves the right to revise this publication and to make changes from time to time in the content hereof without obligation of Elo to notify any person of such revisions or changes.

No part of this publication may be reproduced, transmitted, transcribed, stored in a retrieval system, or translated into any language or computer language, in any form or by any means, including, but not limited to, electronic, magnetic, optical, chemical, manual, or otherwise without prior written permission of Elo Touch Solutions, Inc.

Elo and the Elo logo are either trademarks or registered trademarks of Elo Touch Solutions, Inc.

