

## Box Contents:

- 1x Elo Backpack 5
- 1x 19v DC power brick with security screw
- 2x AC plug adaptors
- 2x Wifi antennas
- 4x M4x35mm pan head screws for mounting between display and stand
- 4x M4x30mm flat head screws for mounting on the rear of Elo IDS

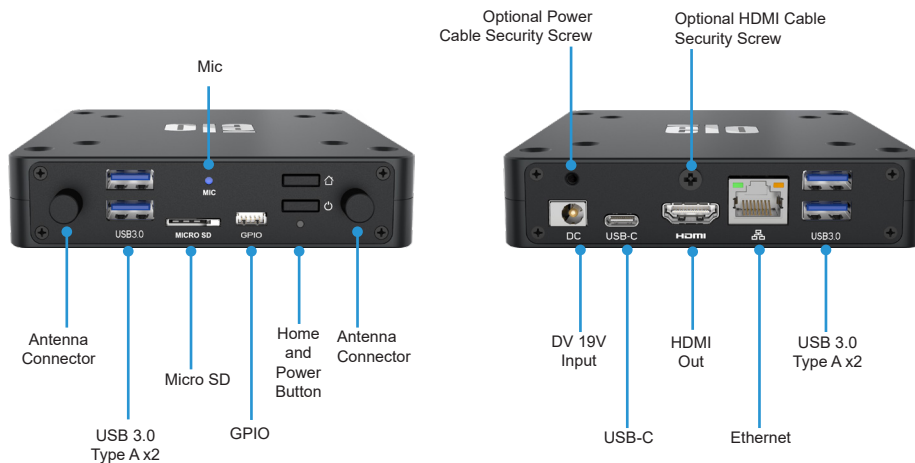

## Quick Installation Guide

# Elo Backpack 5

Revision A  
P/N E319782

Learn more about Elo at [EloTouch.com](https://www.elotouch.com)

### America

800-ELO-TOUCH  
Tel +1 408 597 8000  
[elosales.na@elotouch.com](mailto:elosales.na@elotouch.com)

### Europe (EMEA)

Tel +32 16 930 136  
[emea.sales@elotouch.com](mailto:emea.sales@elotouch.com)

### Asia Pacific

Tel +86 (21) 3329 1385  
[EloAsia@elotouch.com](mailto:EloAsia@elotouch.com)

The information in this document is subject to change without notice. Elo Touch Solutions, Inc. and its Affiliates (collectively "Elo") makes no representations or warranties with respect to the contents herein, and specifically disclaims any implied warranties of merchantability or fitness for a particular purpose. Elo reserves the right to revise this publication and to make changes from time to time in the content hereof without obligation of Elo to notify any person of such revisions or changes.

No part of this publication may be reproduced, transmitted, transcribed, stored in a retrieval system, or translated into any language or computer language, in any form or by any means, including, but not limited to, electronic, magnetic, optical, chemical, manual, or otherwise without prior written permission of Elo Touch Solutions, Inc.

Elo and the Elo logo are either trademarks or registered trademarks of Elo Touch Solutions, Inc..

Go to [www.eotouch.com/support](http://www.eotouch.com/support) to download user manual.

## Step 1 - Optional Step for Permanent Mounting

The Elo Backpack 5™ has both a 75mm and 100mm through-hole mounting pattern. The mounting holes on the top side are countersunk for use with M4 flat-head screws. Screw length and type depends on mounting bracket thickness and what the Elo Backpack is being mounted to.

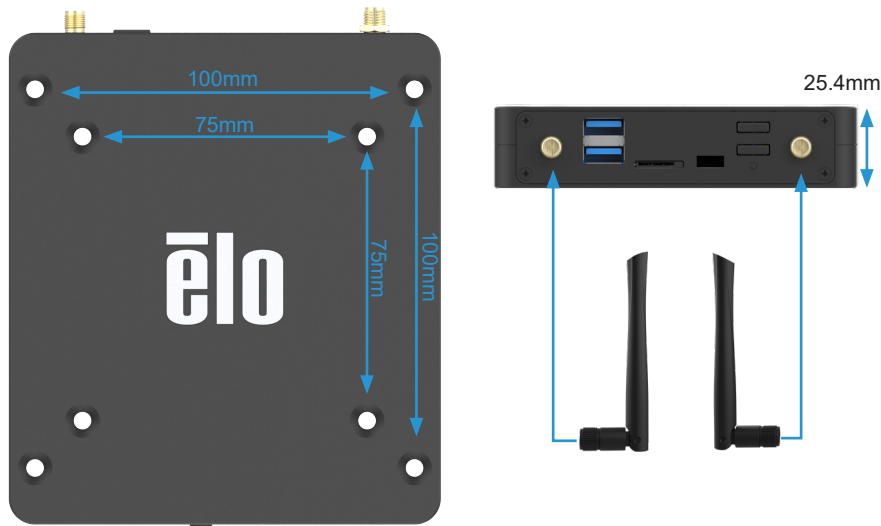

## Step 2 - Connecting device to an Elo Touch Monitor

- Connect 19V DC Power cable.
- Connect HDMI or USB-C cable between Elo touch monitor and Elo Backpack 5.
- If HDMI video is used, a USB cable must also be connected between the Elo Touch Monitor and the Elo Backpack 5 to enable touchscreen functionality.
- Connect Wifi antennas to the noted location above.
- Press the Power button to power on the Elo Backpack 5 if it does not power on automatically.

## Step 3 - Connect device to network

After powering on the Elo Backpack, please choose a set up method. To set up your device with EloView, select the "Enroll with Eloview" option. This will take you to a "Connect to Wi-Fi" page to set up your wireless network if no Ethernet is connected.

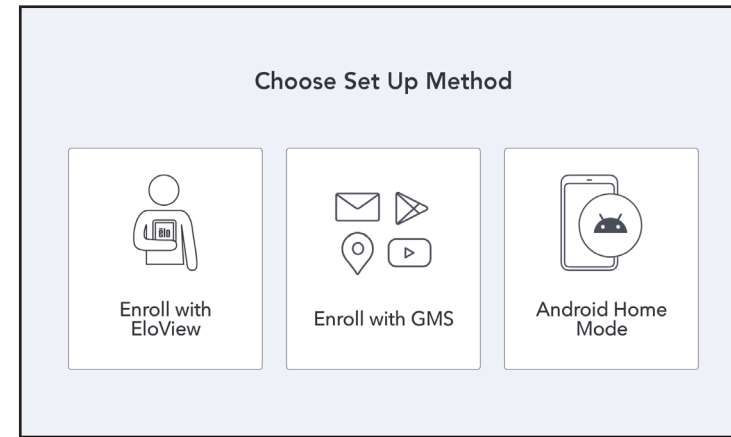

## Step 4 - Add device to EloView®

To add your device to your EloView account, go to the EloView web portal at [manage.eloview.com](http://manage.eloview.com). After logging in, go to the 'Devices' page, then click the 'add device' button. Enter the device serial number and a name for the device. Click 'done'. Your device is now linked to your EloView account and you can assign content to play on the device. If the device is connected via Ethernet the device will automatically load content and settings. Visit [www.eloview.com](http://www.eloview.com) for details.



## EU Battery Regulation

This symbol on the battery(ies) or on the packaging indicates that the battery(ies) provided with this product should not be treated as household waste. Instead, please separate the battery(ies) from other types of waste and recycle them through your local recycling system to protect the environment and health. The chemical symbol for lead (Pb) is added under this symbol if the battery(ies) contains more than 0.004% lead. Additionally, the chemical symbol for cadmium (Cd) is added under this symbol if the battery(ies) contains more than 0.002% cadmium.

For more detailed information about the recycling of these batteries, please contact your local authority or the shop where you purchased the product or batteries.