

## Peripheral connections

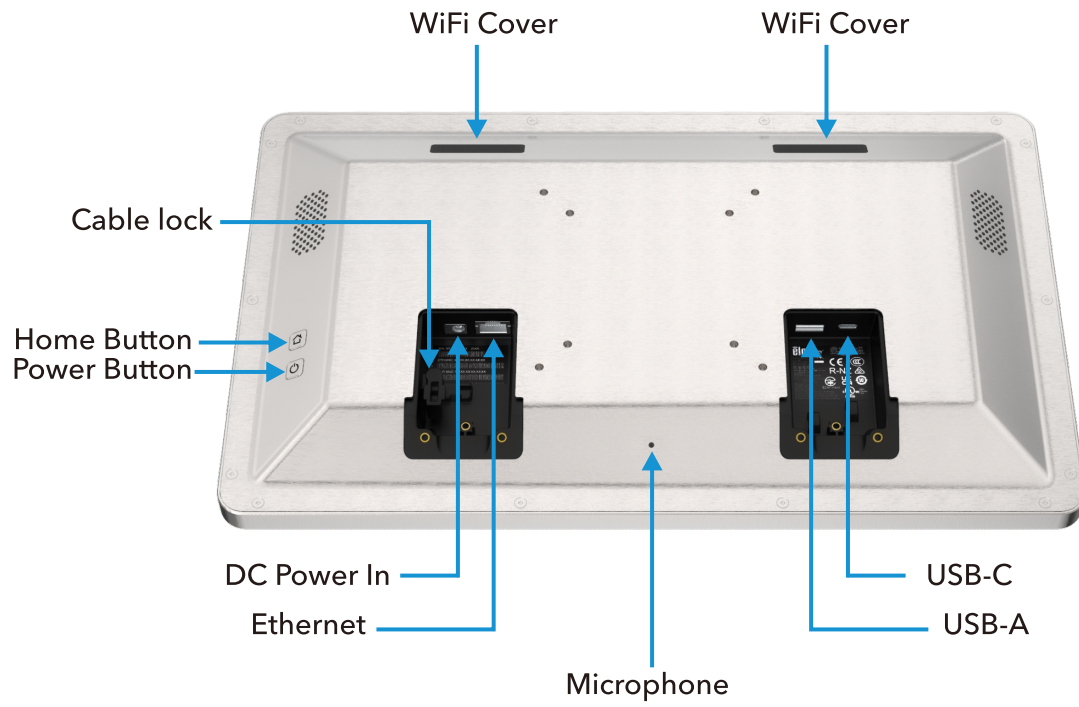

### Contents (without POE) :

- 1x I-Series Steel All-in-One Touchcomputer
- 1x AC-DC Power Adpater
- 1x AC Power Cable (US)
- 1x AC Power Cable (EU)
- 2 x Tie-Wraps (for cable retention)

### Contents (with POE) :

- 1x I-Series Steel All-in-One Touchcomputer
- 2 x Tie-Wraps (for cable retention)



### EU Battery Regulation

This symbol on the battery(ies) or on the packaging indicates that the battery(ies) provided with this product should not be treated as household waste. Instead, please separate the battery(ies) from other types of waste and recycle them through your local recycling system to protect the environment and health. The chemical symbol for lead (Pb) is added under this symbol if the battery(ies) contains more than 0.004% lead. Additionally, the chemical symbol for cadmium (Cd) is added under this symbol if the battery(ies) contains more than 0.002% cadmium.

For more detailed information about the recycling of these batteries, please contact your local authority or the shop where you purchased the product or batteries.

Learn more about Elo at [EloTouch.com](http://EloTouch.com)

**America**  
Tel +1 408 597 8000  
EloSales.NA@elotouch.com

**Europe(EMEA)**  
Tel +32 16 930 136  
EMEA.Sales@elotouch.com

**Asia-Pacific**  
Tel +86 (21) 3329 1385  
EloAsia@elotouch.com

The information in this document is subject to change without notice. Elo Touch Solutions, Inc. and its Affiliates (collectively "Elo") makes no representations or warranties with respect to the contents herein, and specifically disclaims any implied warranties of merchantability or fitness for a particular purpose. Elo reserves the right to revise this publication and to make changes from time to time in the content hereof without obligation of Elo to notify any person of such revisions or changes.

No part of this publication may be reproduced, transmitted, transcribed, stored in a retrieval system, or translated into any language or computer language, in any form or by any means, including, but not limited to, electronic, magnetic, optical, chemical, manual, or otherwise without prior written permission of Elo Touch Solutions, Inc.

Elo and the Elo logo are either trademarks or registered trademarks of Elo Touch Solutions, Inc.



## Quick Installation Guide

### I-Series Steel

Go to [www.elotouch.com/support](http://www.elotouch.com/support) to download user manual.

1

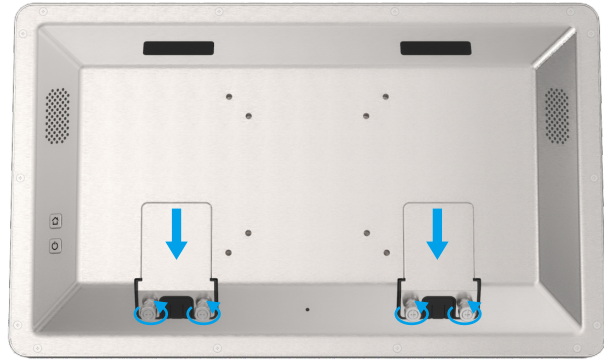

Rotate the thumb screw counterclockwise to loosen it, then slide the cable cover downward to open it.

2

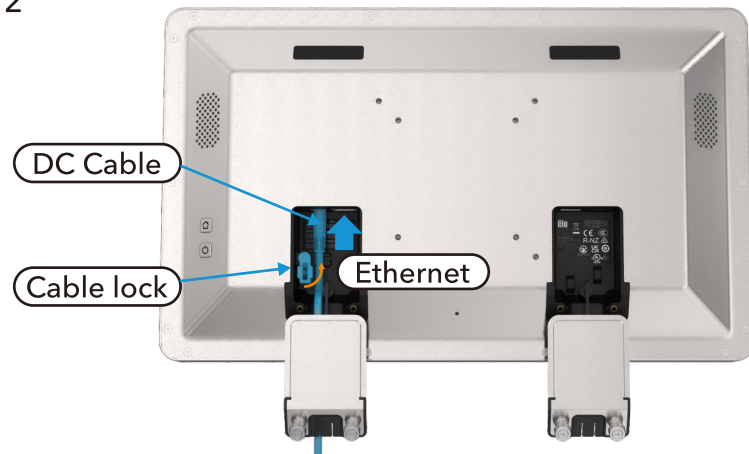

Connect the DC cable. Lift the cable lock upward, rotate it 90 degrees, and lock the DC cable in place.

3

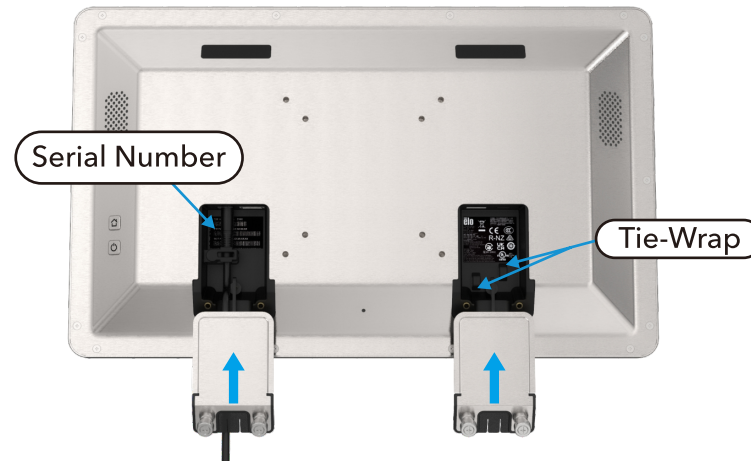

Connect an Ethernet cable now (or setup WiFi later). Tie-wrap (included) can be used to secure the other cables from accidental removal. Slide the cable cover upward.

4



Gently press down on the thumb screw, and rotate it clockwise to reinstall the cable cover. Complete the assembly.

5

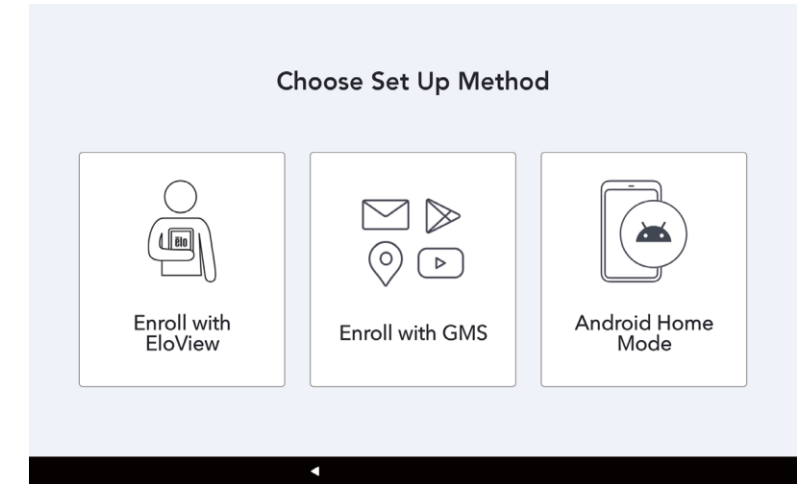

After powering on the Elo I-Series AIO, please choose a set up method. To set up your device with EloView, select the "Enroll with Eloview" option. This will take you to a "Connect to Wi-Fi" page to set up your wireless network if no Ethernet is connected.

6 **Add device to EloView®**

To add your device to your EloView account, go to the EloView web portal at [manage.eloview.com](http://manage.eloview.com). After logging in, go to the 'Devices' page, then click the 'add device' button. Enter the device serial number (see step 3 for location) and a name for the device. Click 'done'.

Your device is now linked to your EloView account and you can assign content to play on the device. If the device is connected via Ethernet the device will automatically load content and settings. Visit [www.eloview.com](http://www.eloview.com) for details.

Note: I-Series Steel without POE powered via DC power interface.  
I-Series Steel with POE powered via Ethernet interface.