

NOTES:

1. ALL DIMENSIONS ARE IN MILLIMETERS AND INCHES.
2. GLASS THICKNESS: 2.7mm[0.106"] NOMINAL.
3. WRAP-AROUND PIEZOS ARE LOCATED ON THE BACK SURFACE OF THE GLASS DIRECTLY OPPOSITE THE GRATING PATTERNS (HEIGHT ADDED: 1.6mm/0.06" MAX).
4. FLEXIBLE PRINTED CIRCUIT (FPC) WIRES ARE ROUTED ON THE BOTTOM SURFACE OF THE GLASS DIRECTLY OPPOSITE THE RECEIVE ARRAY PATTERNS (X AND Y AXIS).
5. FLEXIBLE PRINTED CIRCUIT (FPC) WIRE DIRECTLY MATES WITH INTELLITOUCH CONTROLLERS. REFER TO [WWW.ELTOUCH.COM](http://WWW.ELTOUCH.COM) FOR CONTROLLERS AND ACCESSORIES PART NUMBERS.
6. THE TOUCH ACTIVE AREA IS LESS THAN THE VIEWABLE AREA TO FACILITATE SEALING.
7. 5 PCS OF CLEAR TAPE ARE APPLIED ON TOP SIDE  
4 PCS OF CLEAR TAPE ARE APPLIED ON BOTTOM SIDE

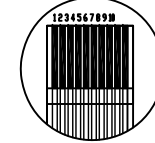

connector contact (0.75 scale)  
DETAIL B

Pin No.	Signal
1	Y transmit -
2	Y transmit +
3	Y transmit -
4	Y receive +
5	Y receive -
6	X receive -
7	X receive +
8	X transmit -
9	X transmit +
10	X transmit -

Signal Assign

Packing condition

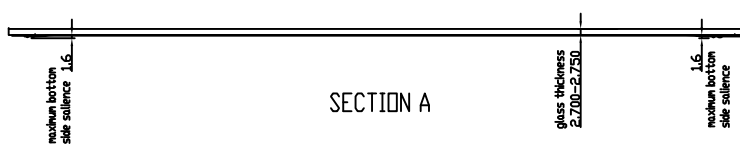
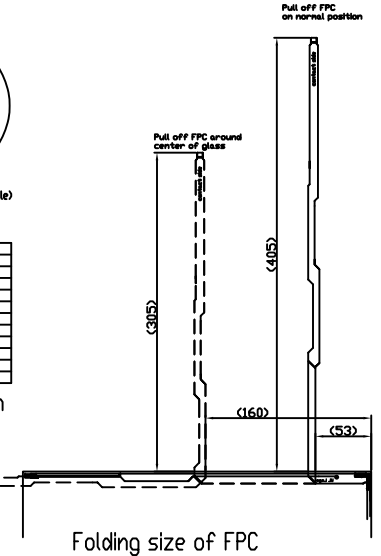

THIS INFORMATION IS CONFIDENTIAL AND PROPRIETARY TO TICO ELECTRONICS CORPORATION AND ITS WORKING SUBSIDIARIES AND SHOULD BE KEPT CONFIDENTIAL. ANY UNAUTHORIZED DISCLOSURE OR REPRODUCTION OF THIS INFORMATION FROM TICO ELECTRONICS CORPORATION, HARRISBURG, PENNSYLVANIA, USA.

LOC  
DIST

P	LTR	REVISION RECORD	DATE	DN	APVD
A		RELEASE PER ECO-13-0726	9/18/13	YT	

DIMENSIONS: mm

TOLERANCES UNLESS OTHERWISE SPECIFIED:

0 PLC	±
1 PLC	±
2 PLC	±
3 PLC	±
4 PLC	±

ANGLES: -

SURFACE TEXTURE ANTIGLARE ✓

TOUCHSCREEN TABURATION		
PART NUMBER	DESCRIPTION	SURFACE FINISH
E601840	SCN-IT-SFP15.0-D97-J00-R	CLEAR
E864628	SCN-IT-SFP15.0-D97-J03-R	ANTIGLARE

DN	1/9/2004	TECHNOLOGY	INTELLITOUCH	SURFACE TREATMENT	N/A
Y.T.					N/A
DN					N/A
APVD		<b>elo</b> TOUCH SOLUTIONS			

NAME: DIMENSIONAL DWG, SCN-IT-SFP15.0-D97-J0X-R

SCALE: 1:1 SIZE: A2 DRAWING NO: MS600980 SHEET 1 OF 2 REV: A

MSG00980

THIS DRAWING IS A CONTROLLED DOCUMENT.

PART NO. SEE TABURATION

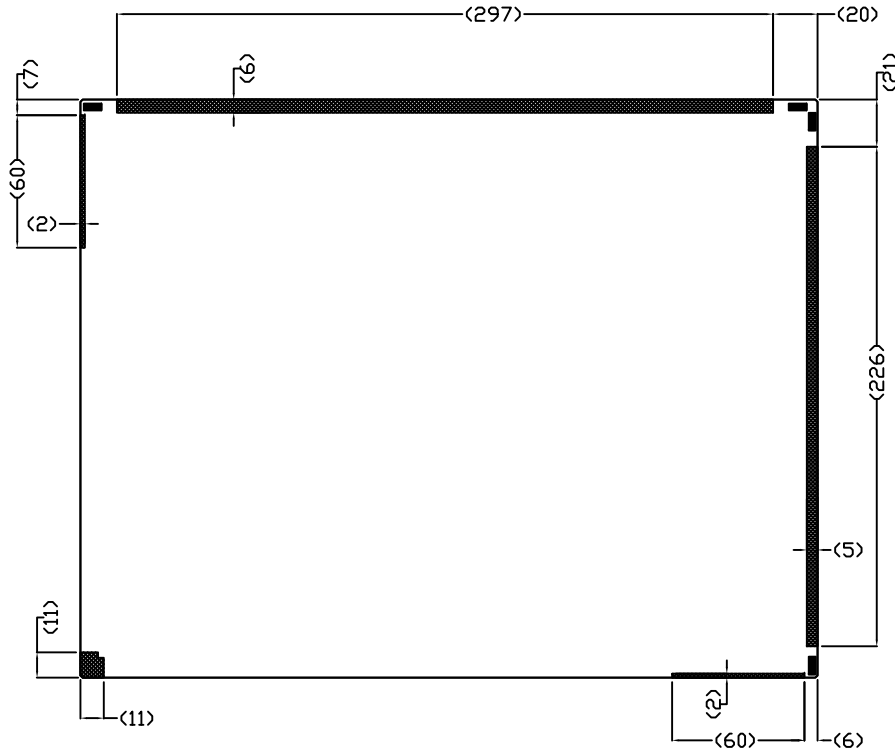

CLEAR TAPE POSITION ON TOP SIDE (view from top side)

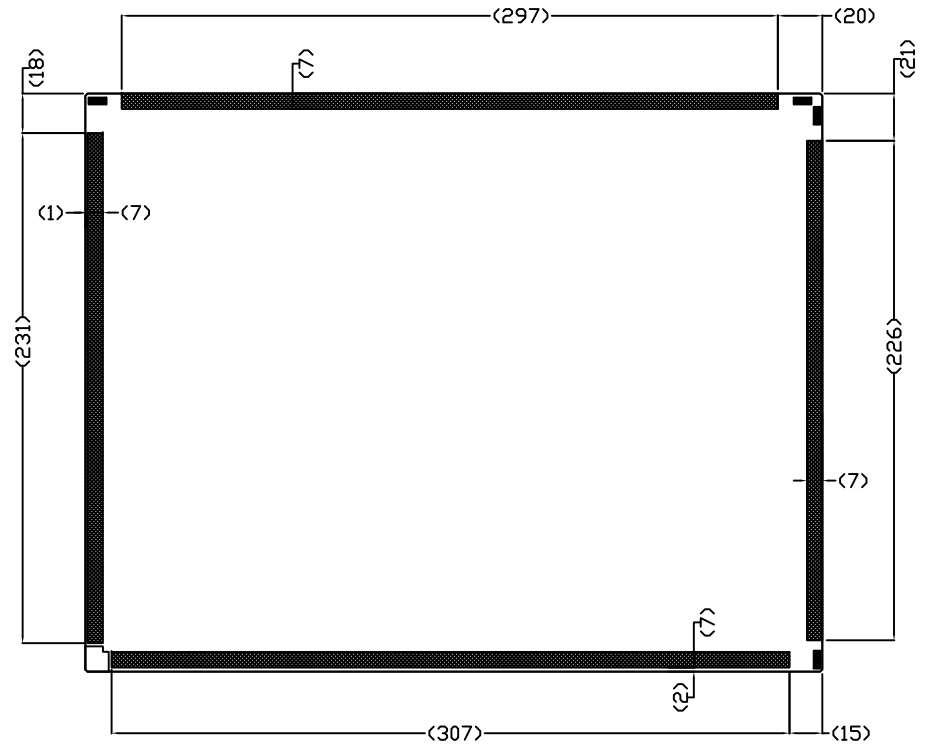

CLEAR TAPE POSITION ON BOTTOM SIDE (view from top side)

THIS INFORMATION IS CONFIDENTIAL AND PROPRIETARY TO TIPO ELECTRONICS CORPORATION AND ITS WORKFORCE SUBSIDIARIES AND EMPLOYEES. IT IS TO BE KEPT SECRET AND NOT TO BE DISCLOSED OR REPRODUCED IN ANY MANNER WITHOUT WRITTEN AUTHORIZATION FROM TIPO ELECTRONICS CORPORATION, WARRENSBURG, PENNSYLVANIA, USA.

LOC  
DIST

P	LTR	REVISION RECORD	DATE	DN	APVD
-	-	SEE FIRST PAGE	-	-	-

DIMENSIONS:	TOLERANCES UNLESS OTHERWISE SPECIFIED:
mm	
0 PLC	±
1 PLC	±
2 PLC	±
3 PLC	±
4 PLC	±

DN	1/9/2004	TECHNOLOGY	INTELLITOUCH	SURFACE TREATMENT	N/A
Y.T.	-				N/A
DN	-				
APVD	-				
NAME	DIMENSIONAL DWG, SCN-IT-SFP15.0-D97-J0X-R				
SCALE	1:1	SIZE	A2	DRAWING NO	MS600980
SHEET	2	OF	2	REV	A

AMP 3307-7 REV 31MAR2000

8

7

6

5

4

3

2

1

D

C

B

A