

NOTE:
ALL DIMS. +/- 1mm UNLESS NOTED

INTELLITOUCH / SECURE TOUCH MODELS ONLY

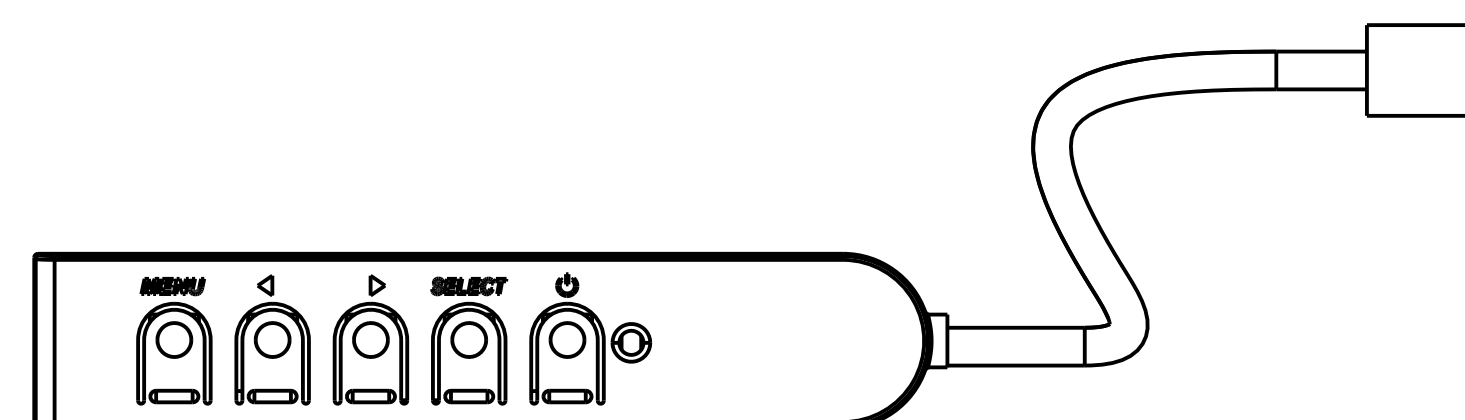

OPTIONAL OSD REMOTE P/N E483757
(ORDERED SEPARATELY)

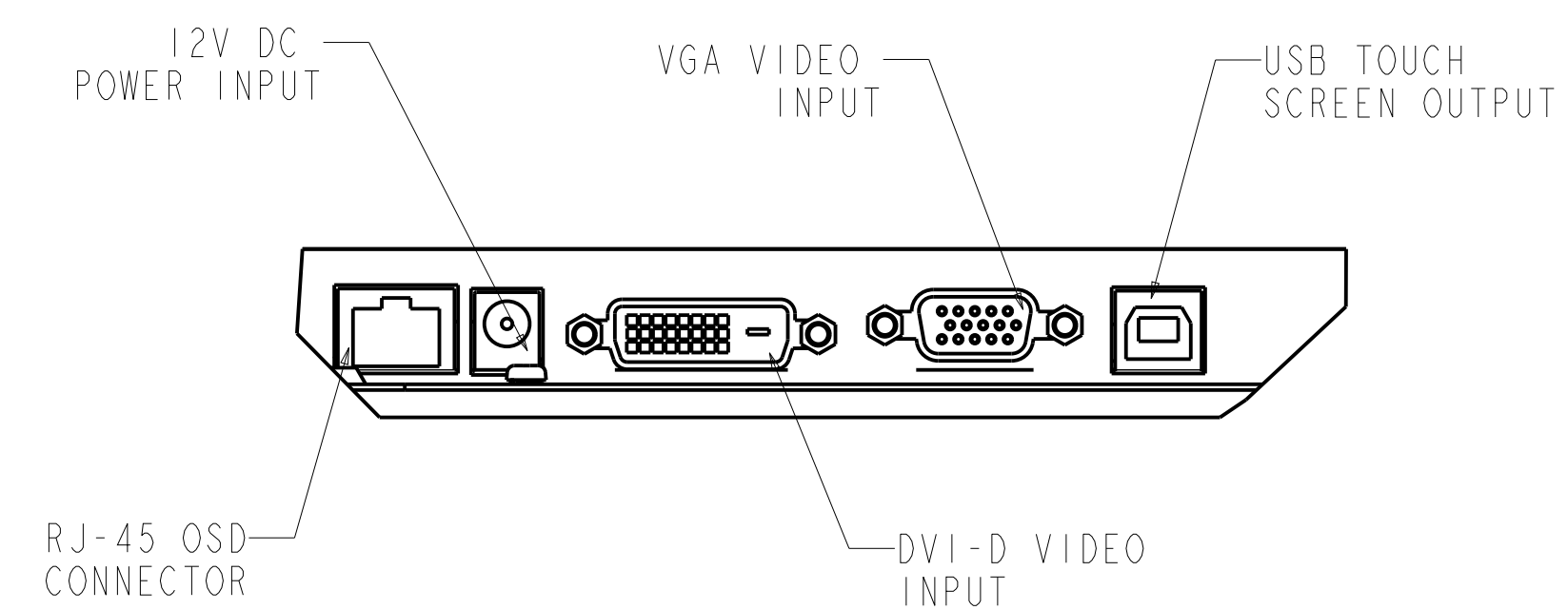
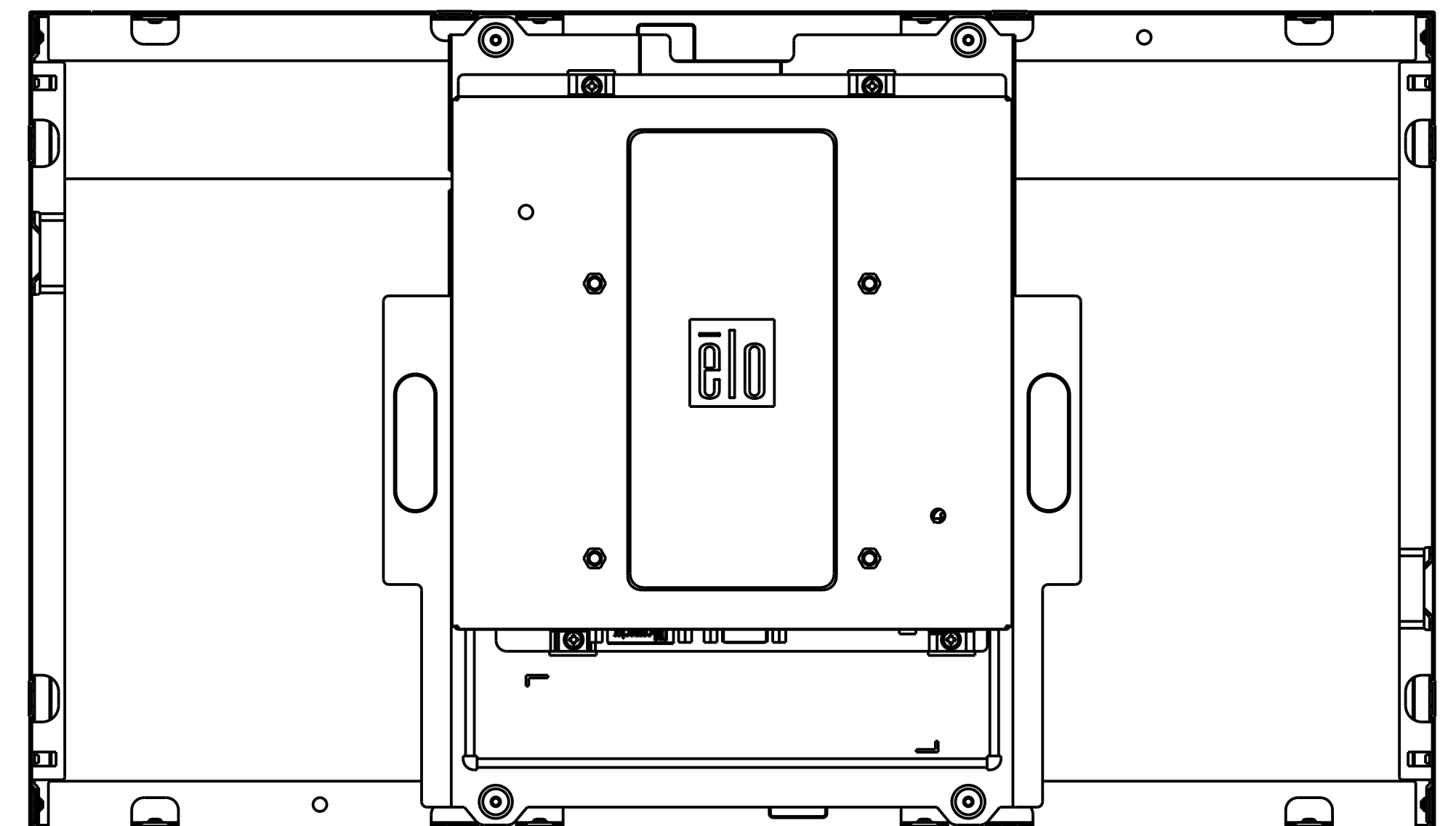
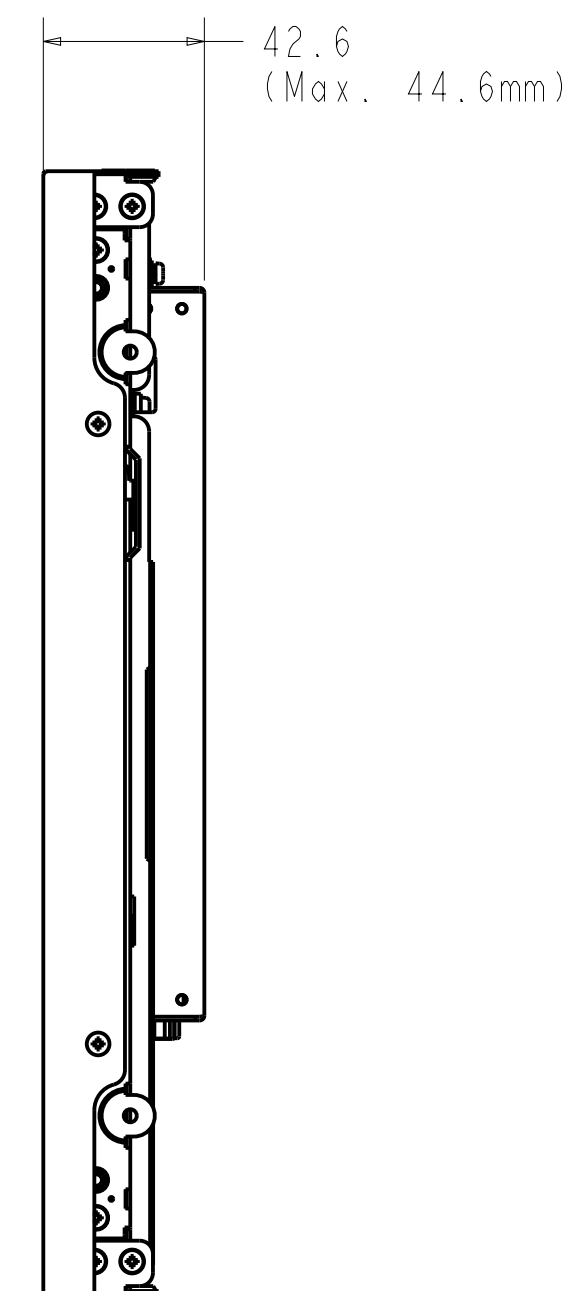
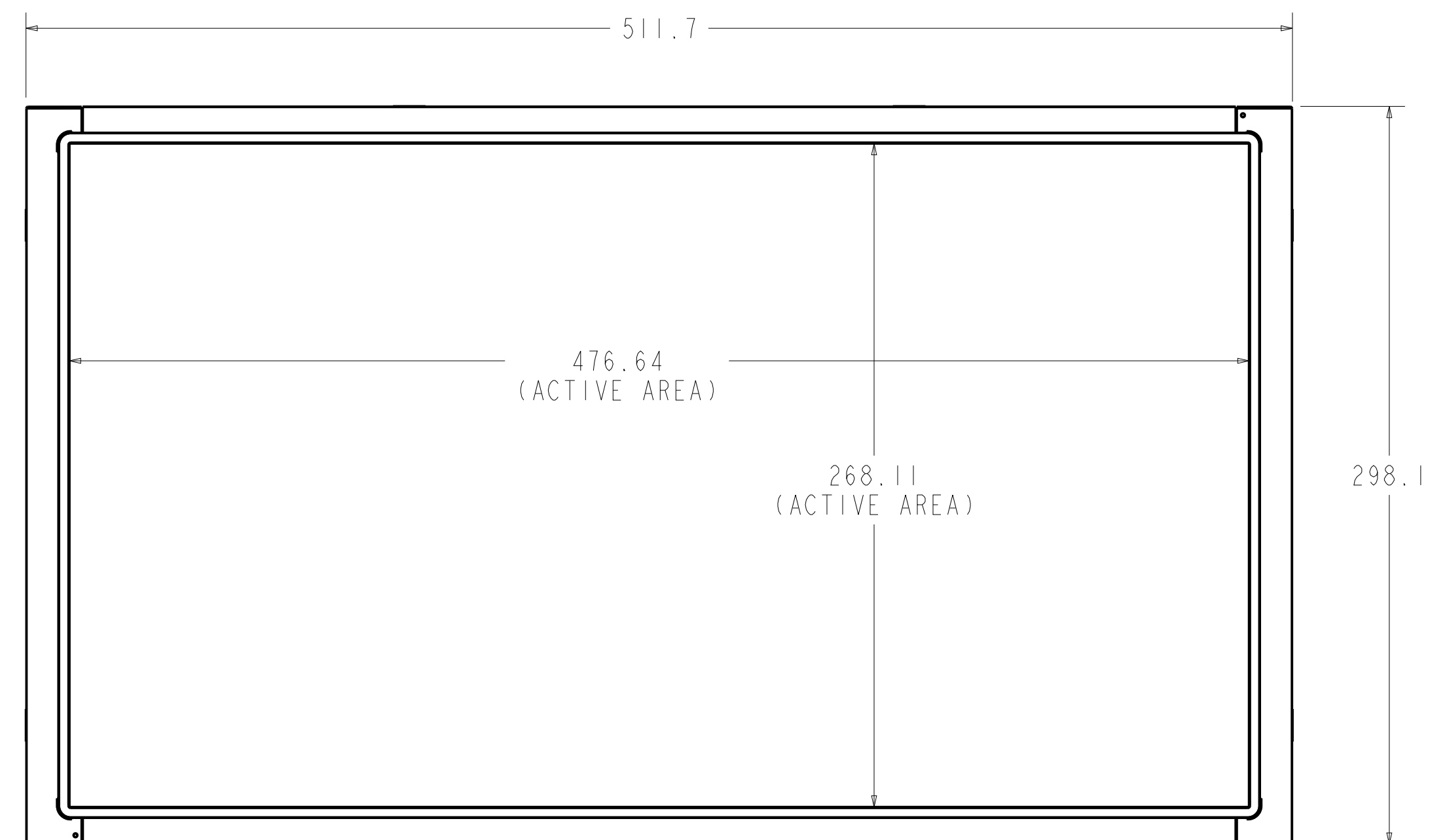
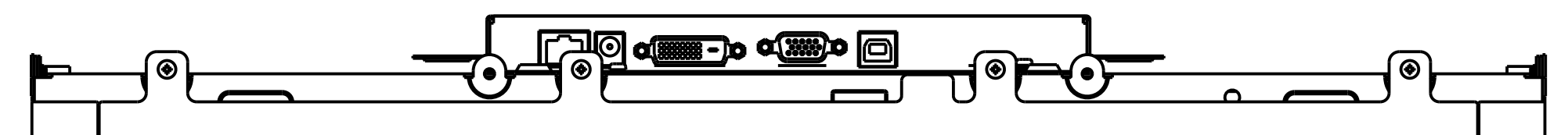

INTELLITOUCH / SECURE TOUCH MODELS ONLY

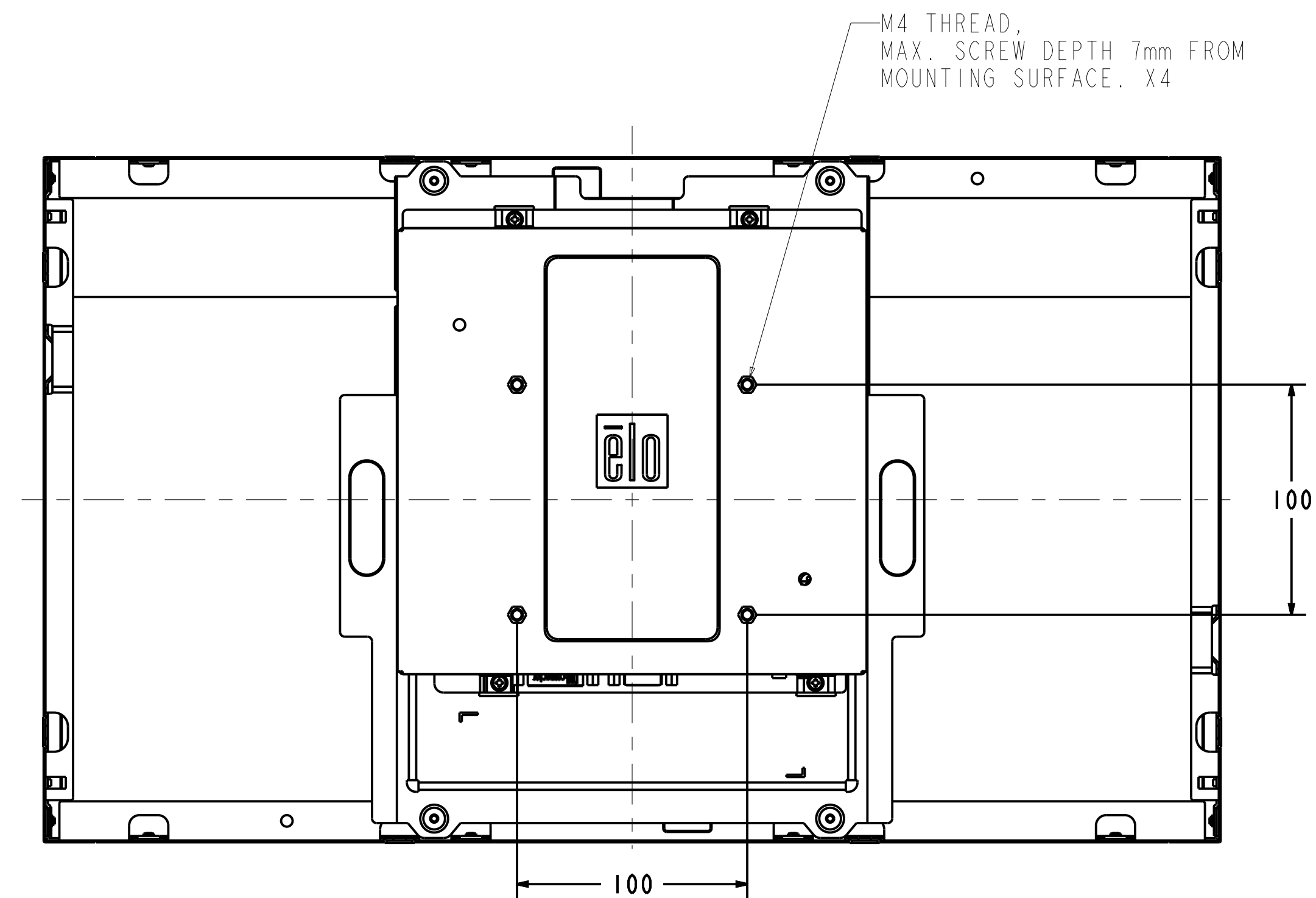

VESA MOUNT

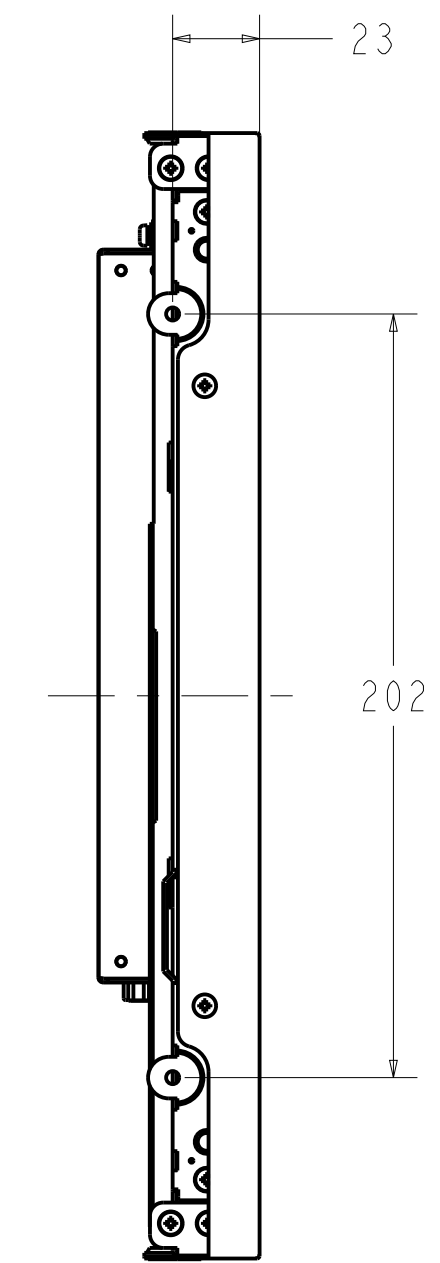

SIDE MOUNT, VERTICAL (LEFT & RIGHT)

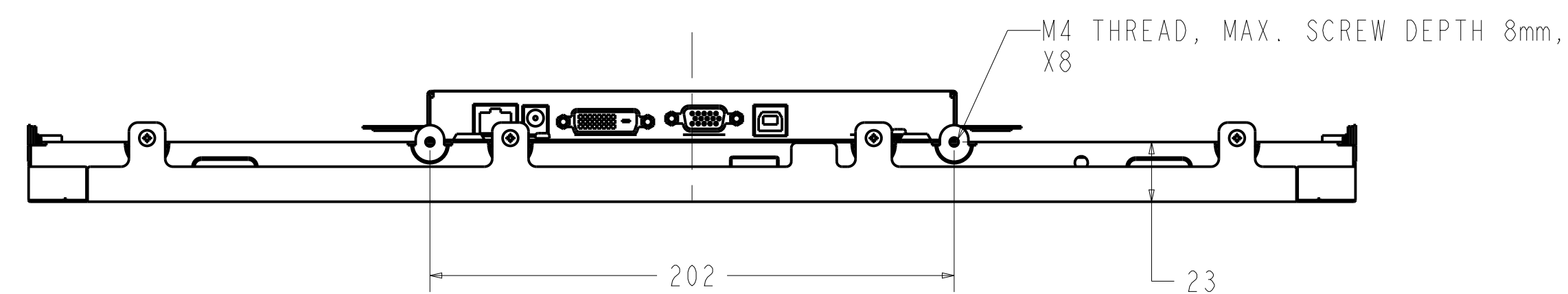

SIDE MOUNT, HORIZONTAL (TOP & BOTTOM)

INTELLITOUCH / SECURE TOUCH MODELS ONLY

MOUNTING WITH ADJUSTABLE BRACKETS
(4 PROVIDED)

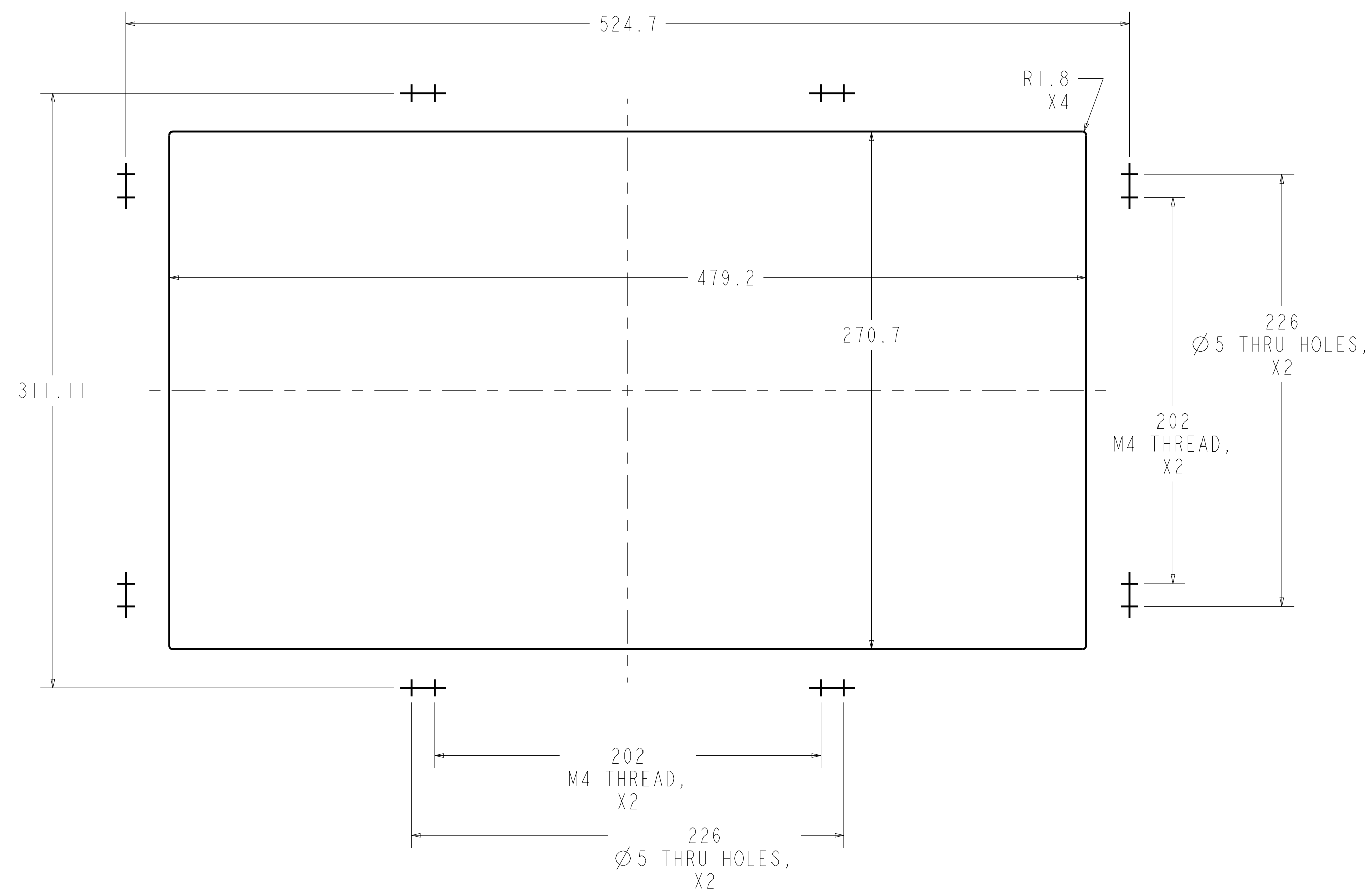

RECOMMENDED CUSTOMER
PANEL CUT-OUT

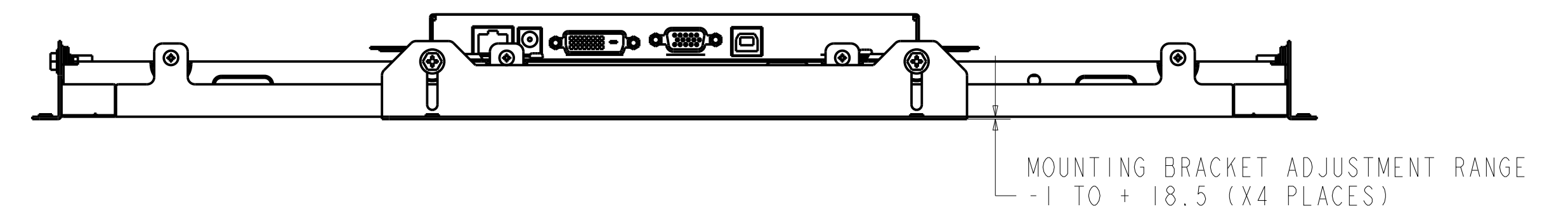
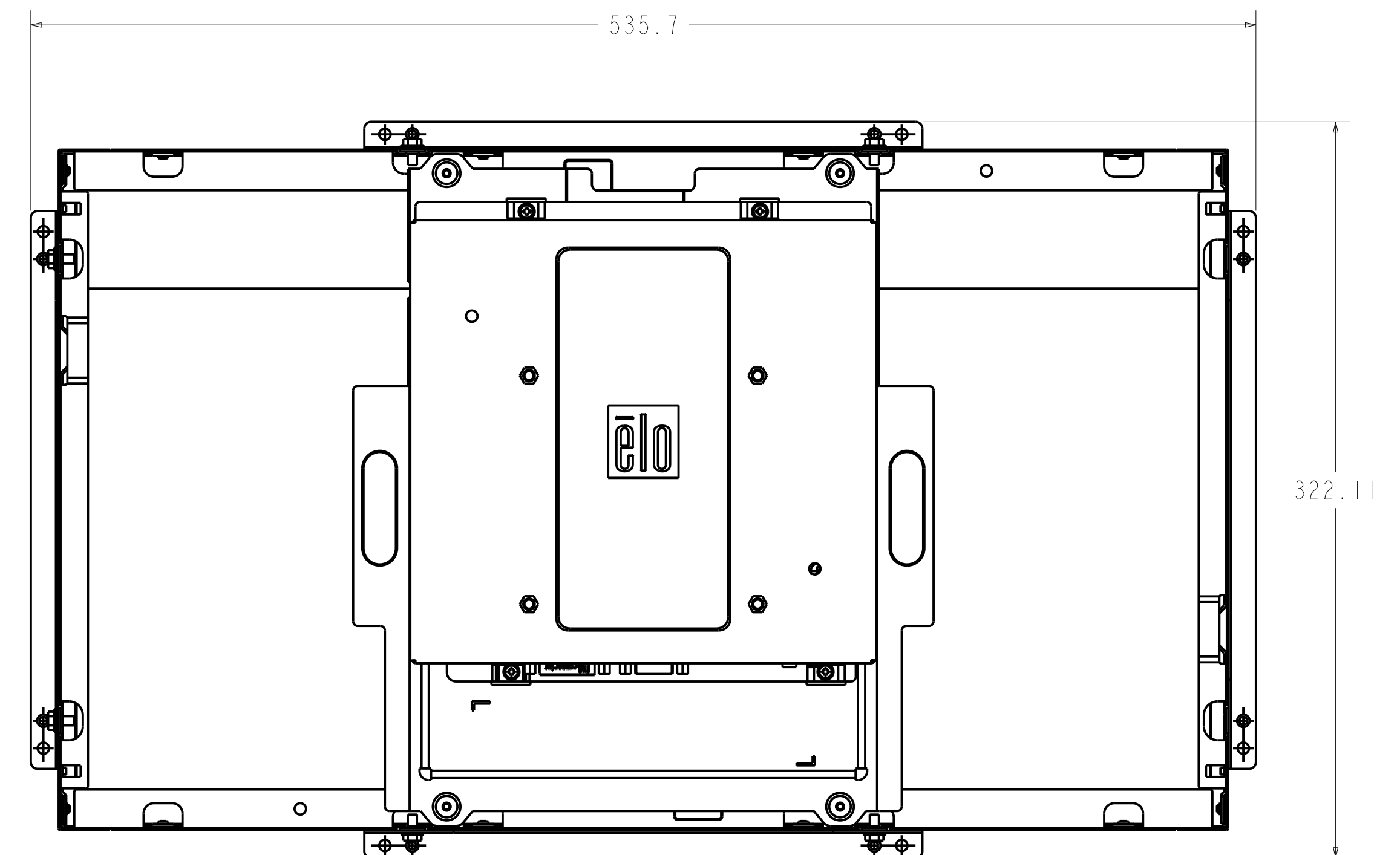

INTELLITOUCH / SECURE TOUCH MODELS ONLY

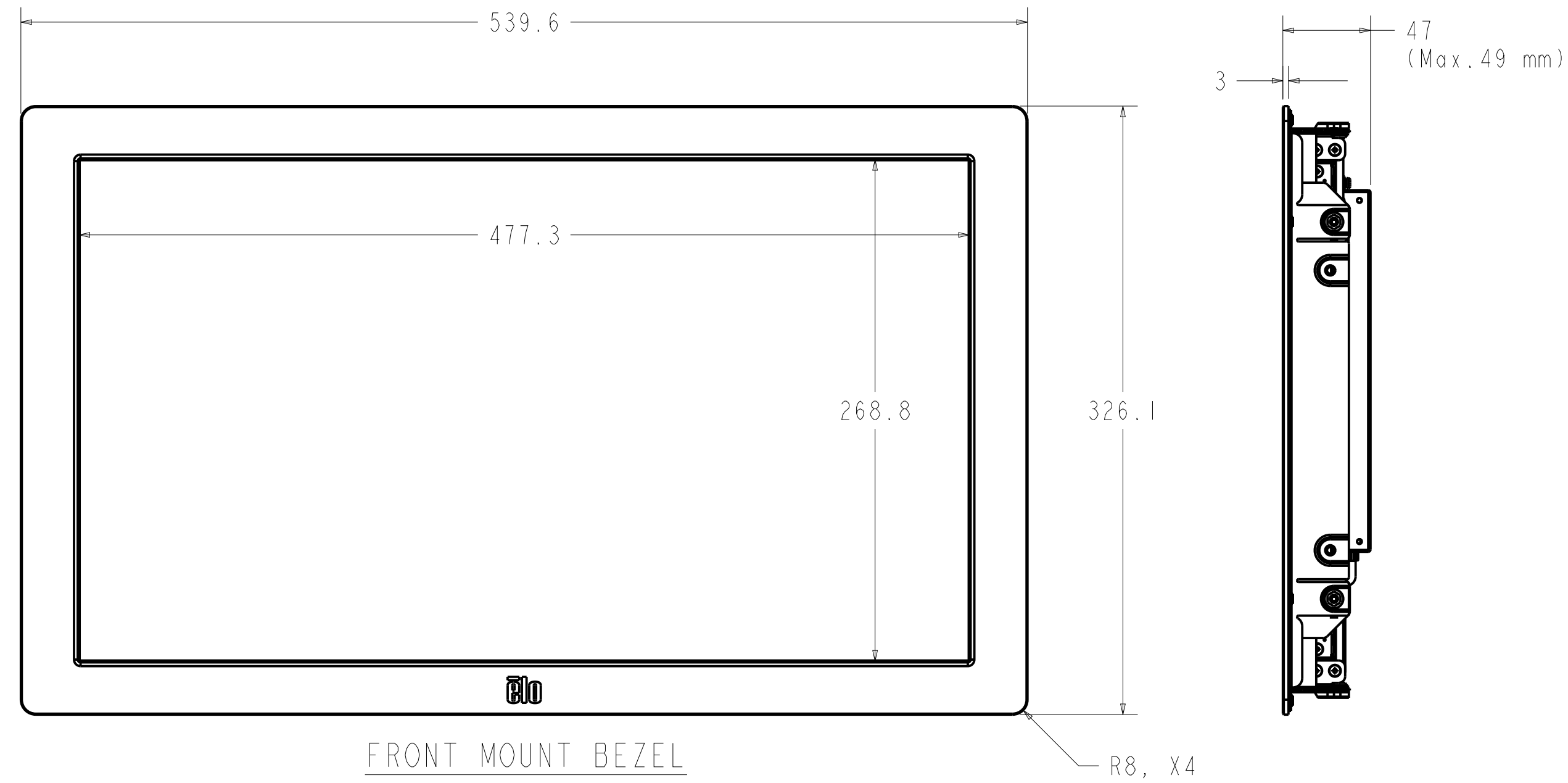

OPTIONAL FRONT MOUNT BEZEL KIT P/N E668194
(ORDERED SEPARATELY, CUSTOMER ASSEMBLED)

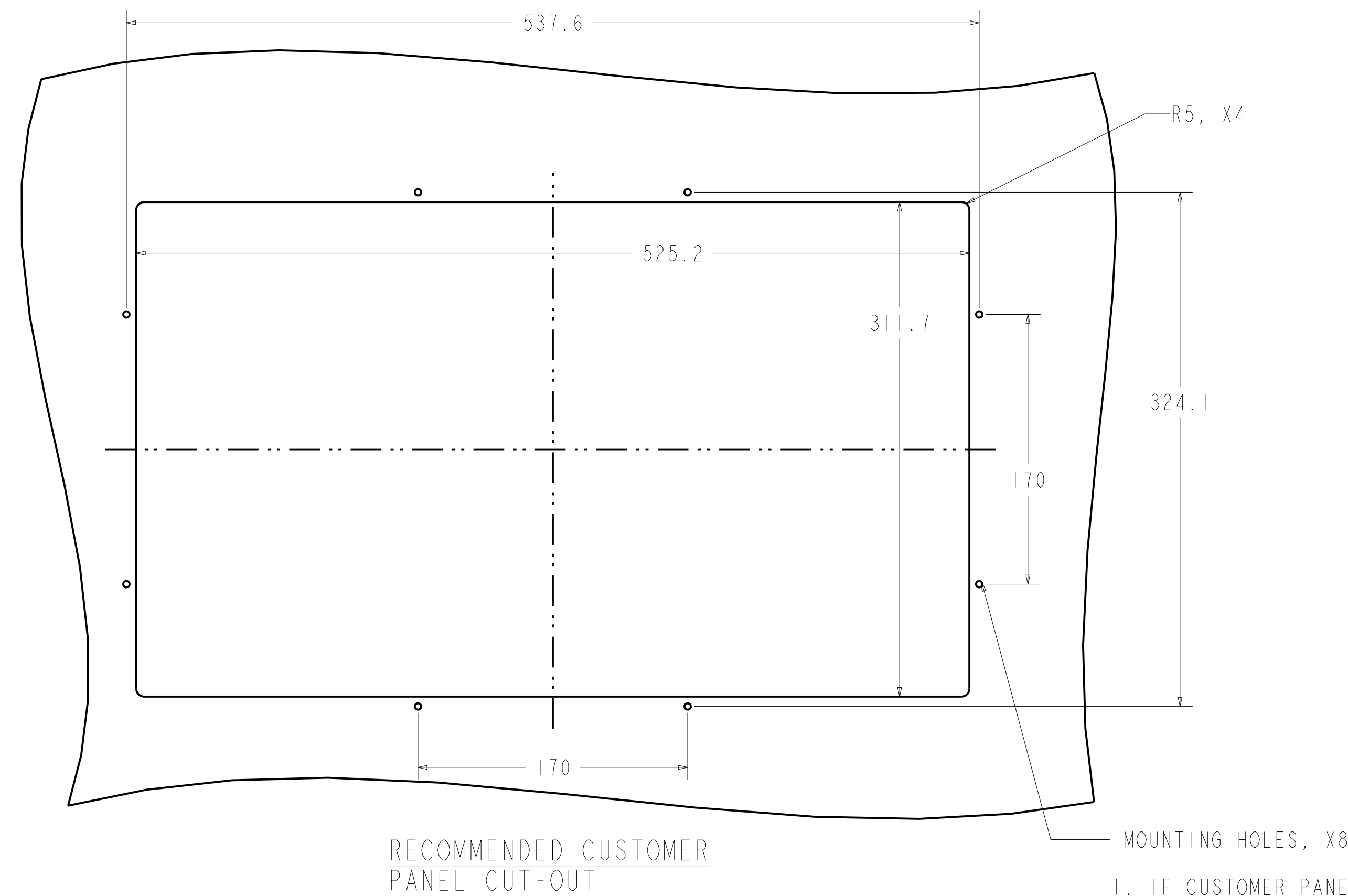

1. IF CUSTOMER PANEL IS WOOD,
Ø4.5MM THRU HOLES FOR M4 SCREWS
OR NO THRU HOLES, SCREWS FOR WOOD Ø4MM
2. IF CUSTOMER PANEL IS SHEET METAL,
CONCEALED HEAD THREADED STUDS M4 WITH NUTS

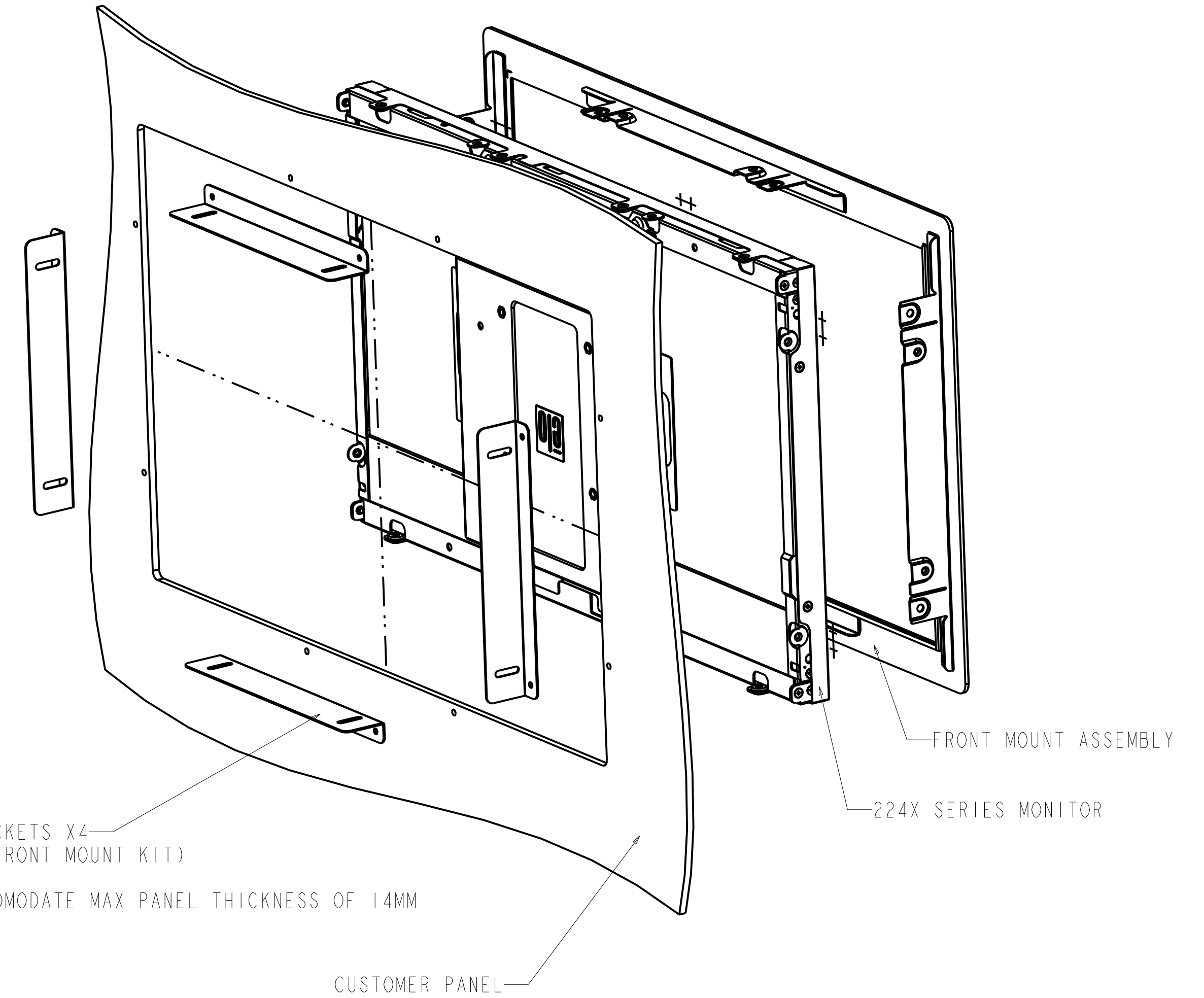

INTELLITOUCH MODELS ONLY

OPTIONAL RACK MOUNT KIT P/N E462672
(ORDERED SEPARATELY, CUSTOMER ASSEMBLED)

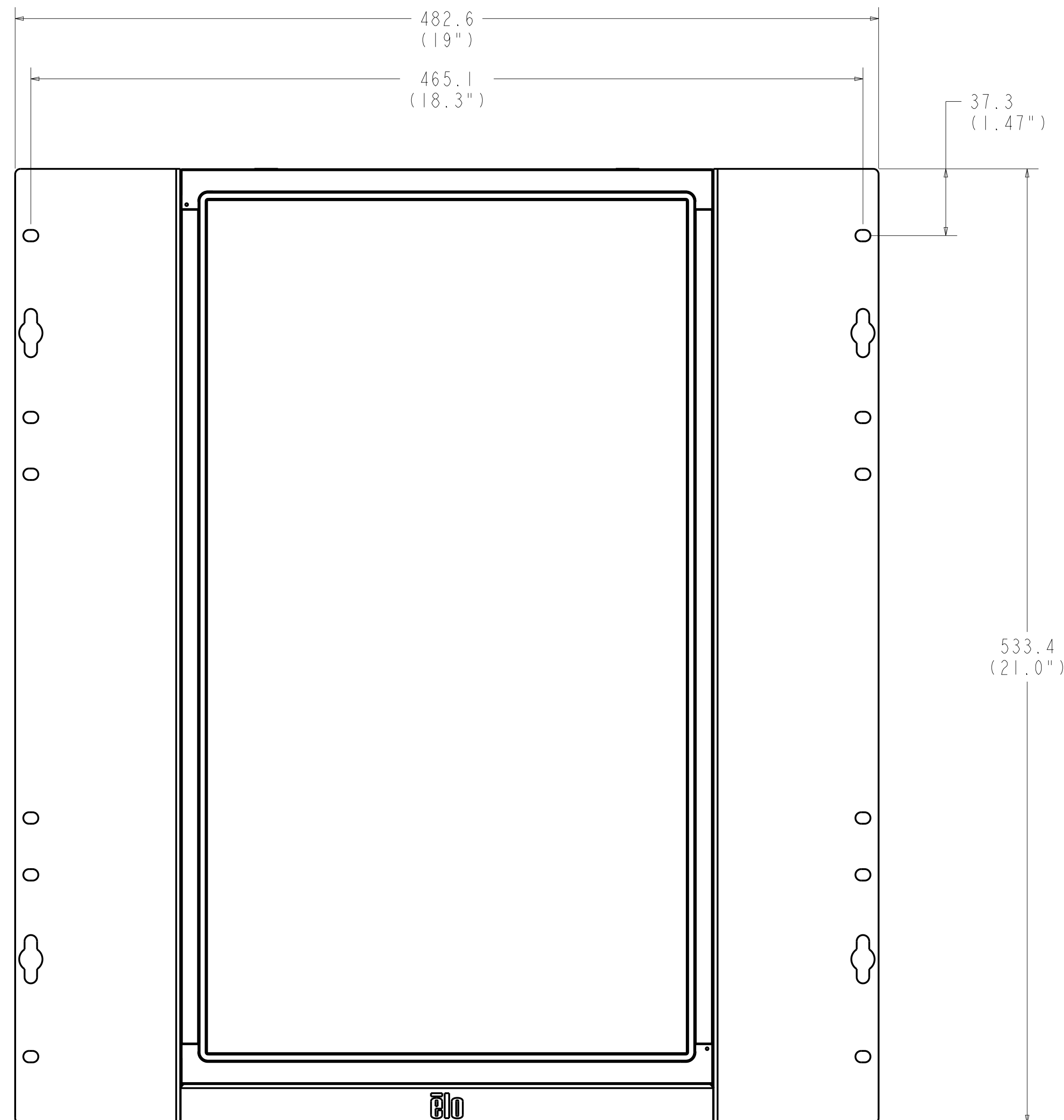

NOTE:
1. MONITOR IS ORIENTED IN PORTRAIT MODE
2. REQUIRES 12U OF RACK SPACE
3. MOUNTING HOLES SPACING PER EIA-310-D

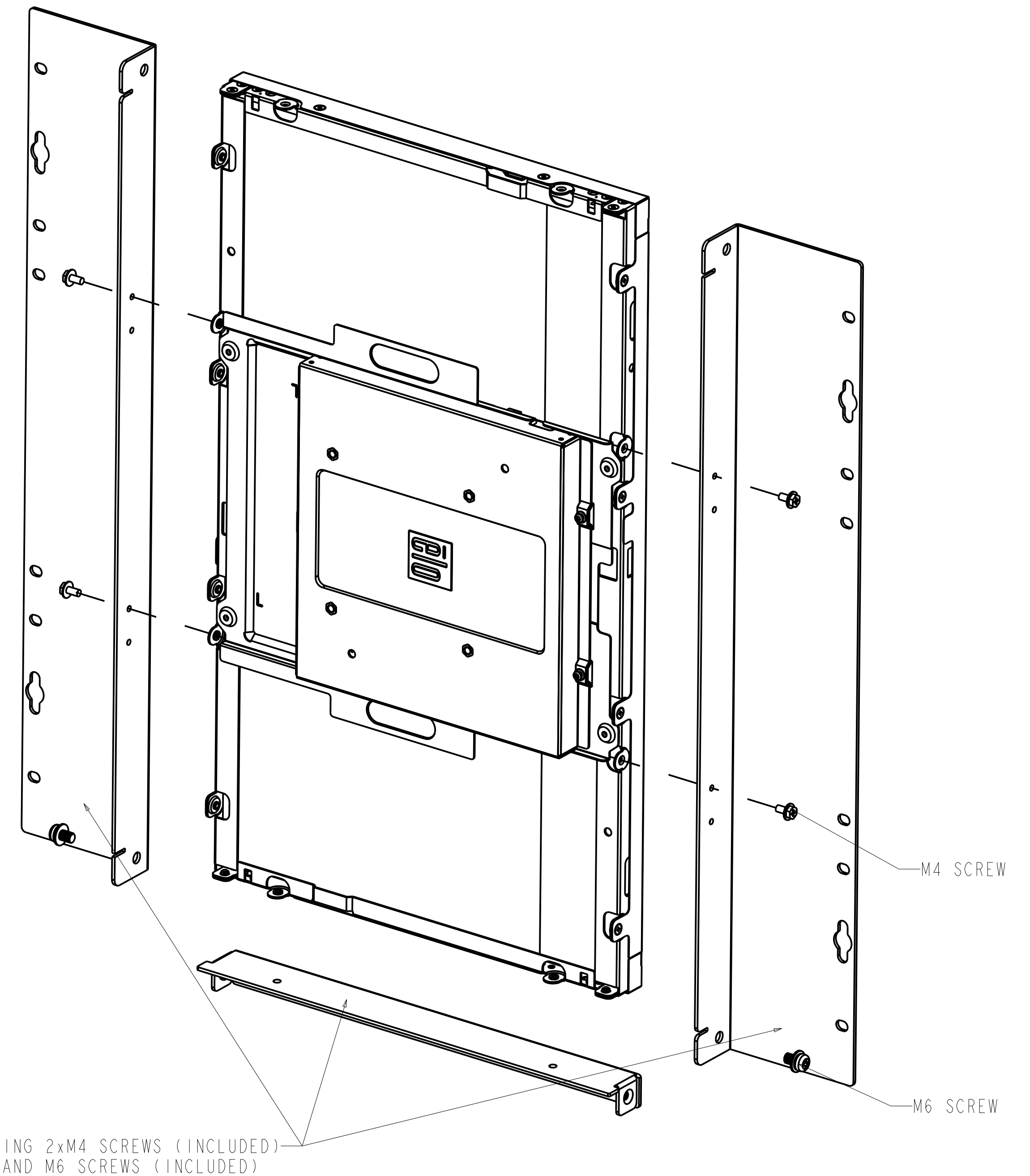

PROJECTED CAPACITIVE MODELS ONLY

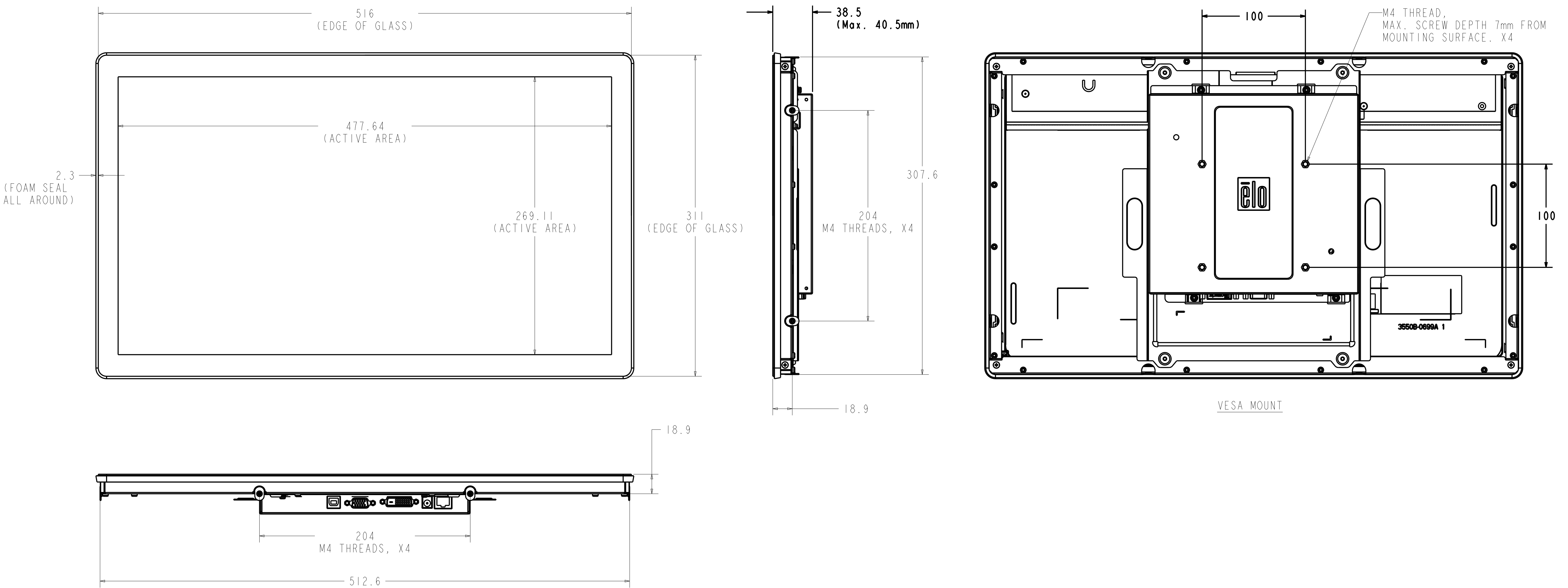

PROJECTED CAPACITIVE MODELS ONLY

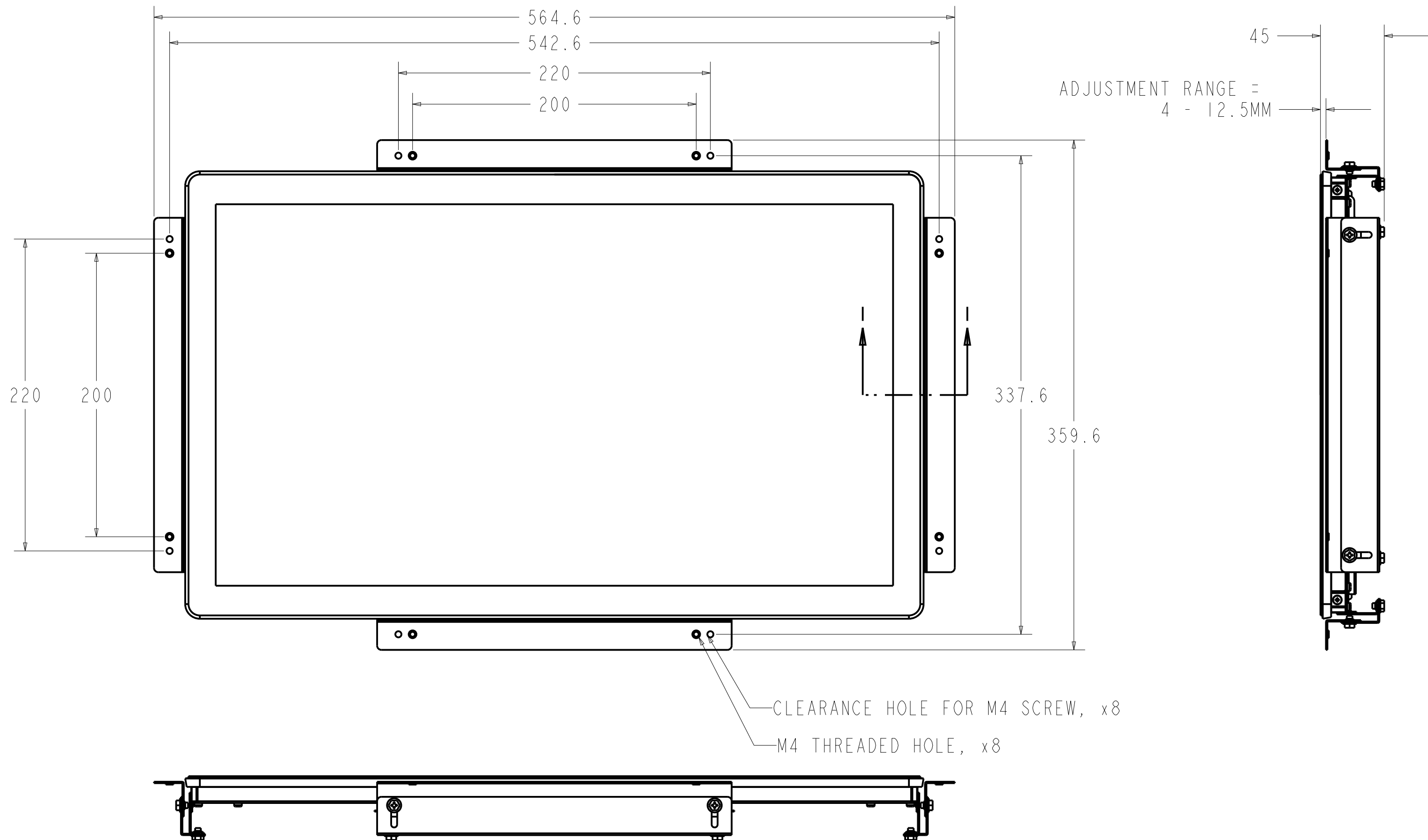

CLEARANCE HOLE FOR M4 SCREW, x8
M4 THREADED HOLE, x8

- INSTALLATION NOTES:
1. ATTACH BRACKET "A" TO TOUCHMONITOR WITH M4 LOW PROFILE SCREWS (INCLUDED)
 2. ATTACH BRACKET "C" TO CUSTOMER PANEL PER DRAWING
 3. ATTACH BRACKET "B" TO BRACKET "C" WITH M4 HEX HEAD SCREWS (INCLUDED)
 4. ADJUST DEPTH OF BRACKET "B" SO MONITOR IS FLUSH WITH CUSTOMER PANEL.
 5. PLACE TOUCHMONITOR INTO CUSTOMER PANEL OPENING TAKING CARE NOT TO DAMAGE FOAM SEAL
 6. SECURE TOUCHMONITOR TO BRACKET "B" FROM BEHIND WITH M4 HEX HEAD SCREWS (INCLUDED)

TOUCHSCREEN SURFACE
CAUTION: WHEN ASSEMBLED, TOUCHSCREEN SURFACE MUST NOT PROTRUDE BEYOND CUSTOMER PANEL SURFACE ANYWHERE AROUND BORDER OF SCREEN

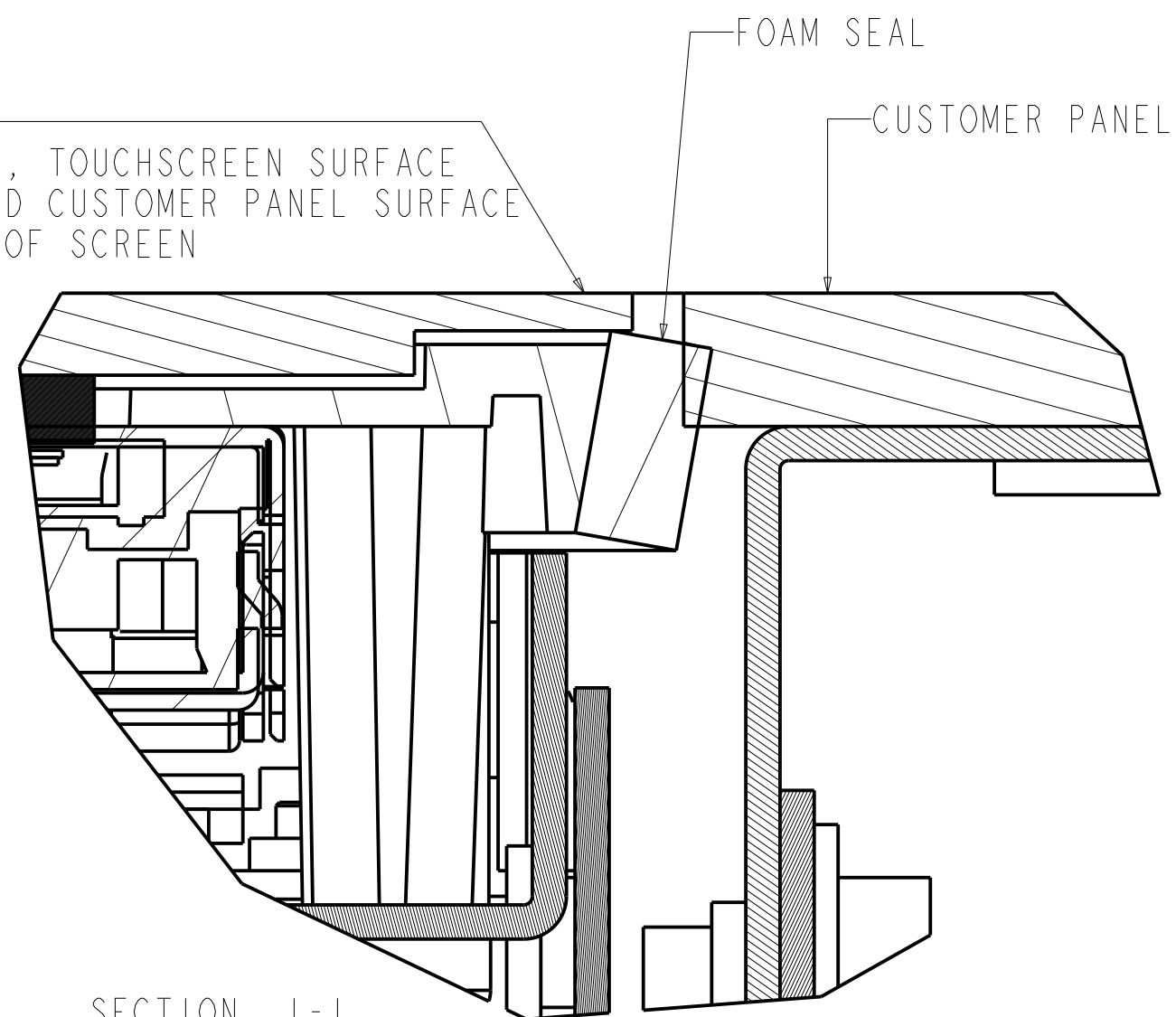

SECTION I-I
SCALE 5.000

RECOMMENDED CUSTOMER PANEL CUT-OUT

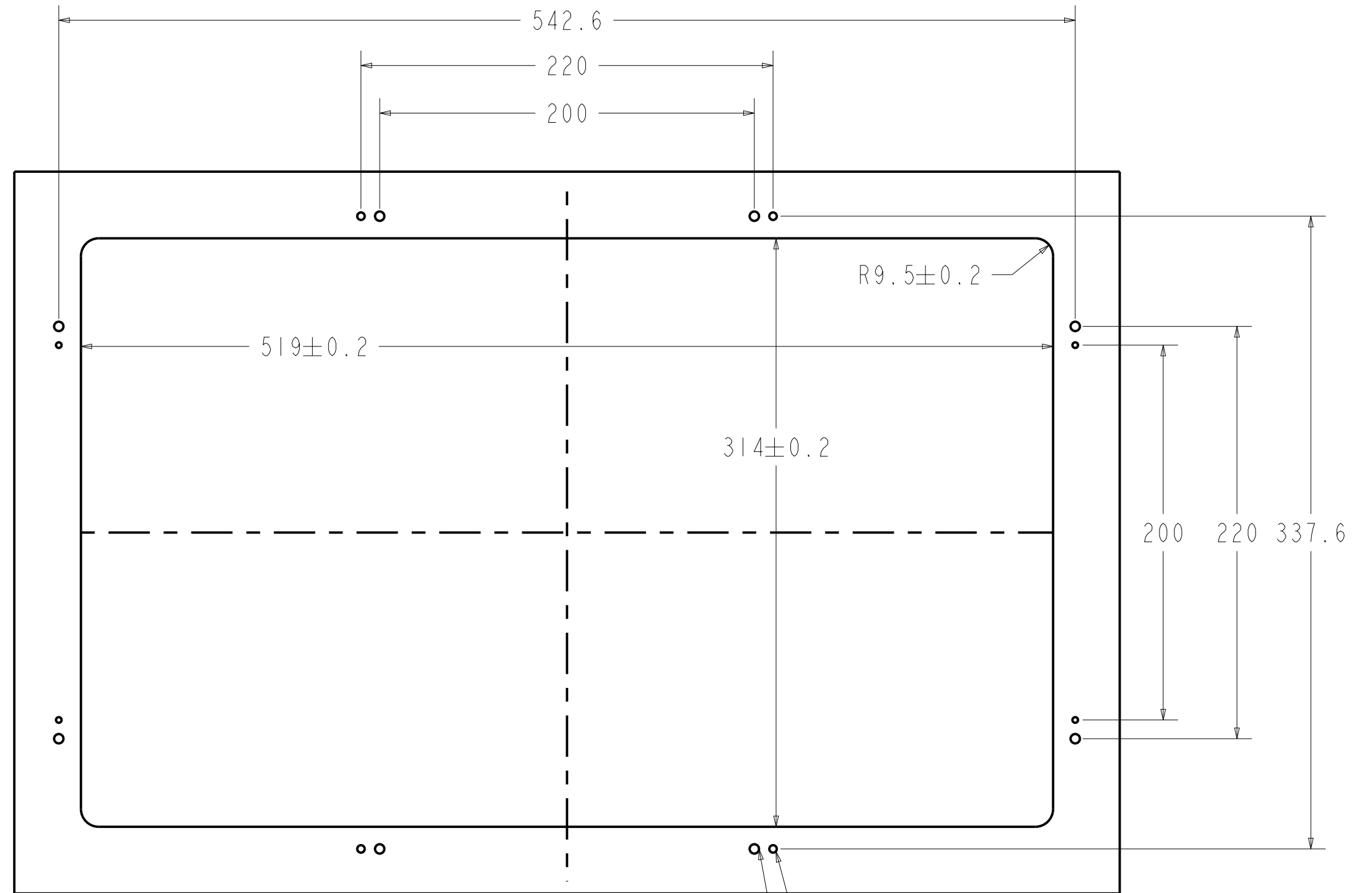

MOUNTING HOLE, x8
IF CUSTOMER PANEL IS METAL, BLIND HOLE, M4 THREAD
CLEARANCE HOLE FOR M4 THREADS ON BRACKET, x8

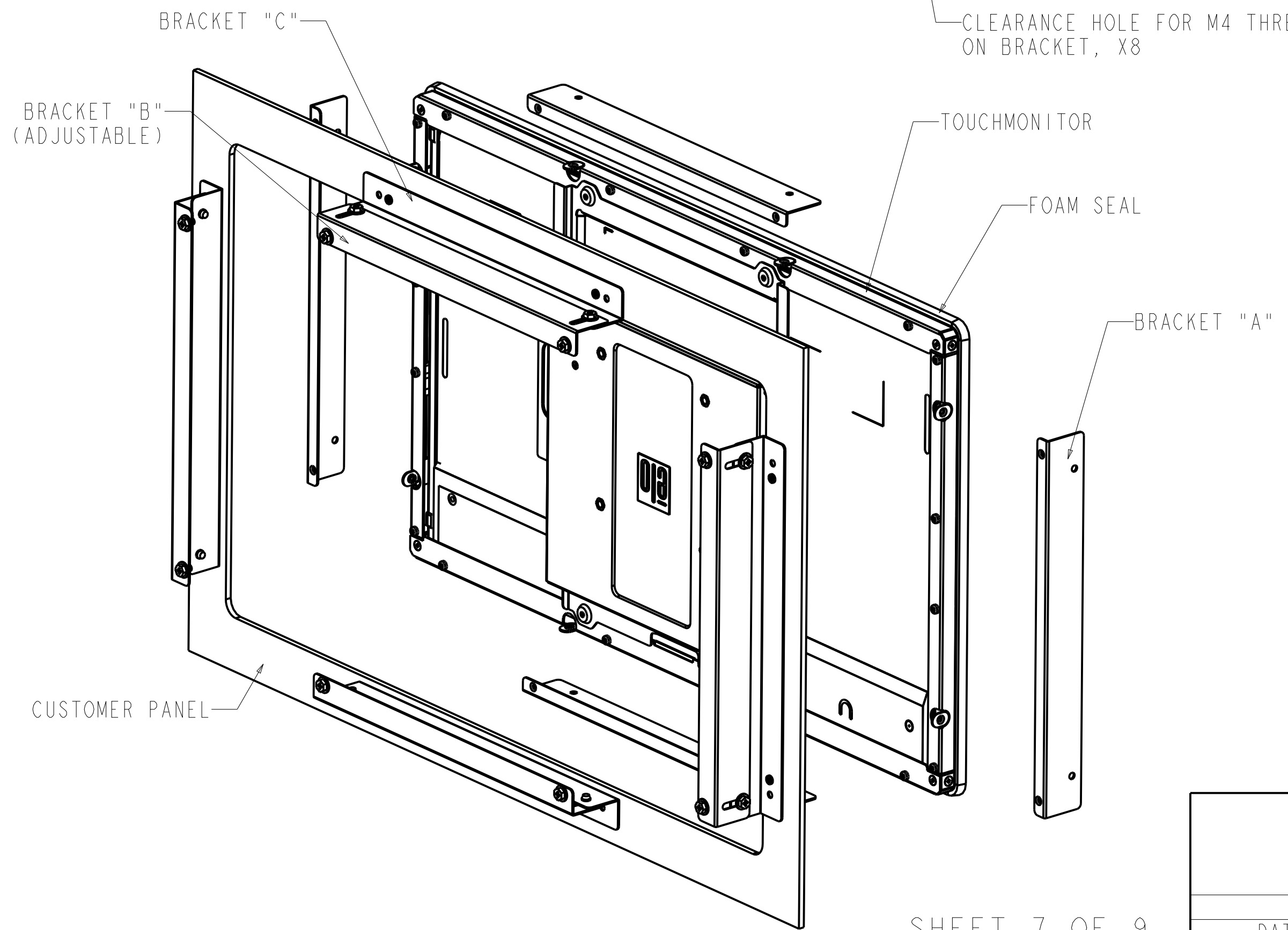



iTOUCH / NO TOUCH(ZB) MODELS ONLY

- INSTALLATION NOTES:
1. ATTACH BRACKET "A" TO CUSTOMER PANEL "C" PER DRAWING
 2. ATTACH BRACKET "B" TO BRACKET "A" WITH M4 HEX HEAD SCREWS "B-1" (INCLUDED)
 3. PLACE TOUCH MONITOR INTO CUSTOMER PANEL OPENING TAKING CARE NOT TO DAMAGE FOAM SEAL
 4. ADJUST DEPTH OF BRACKETS "B" SO MONITOR IS SLIGHTLY PROUD OF CUSTOMER PANEL (~1mm)
 5. SECURE TOUCHMONITOR TO BRACKET "B" + "A" FROM BEHIND WITH M4 HEX HEAD SCREWS "C-1" (INCLUDED)

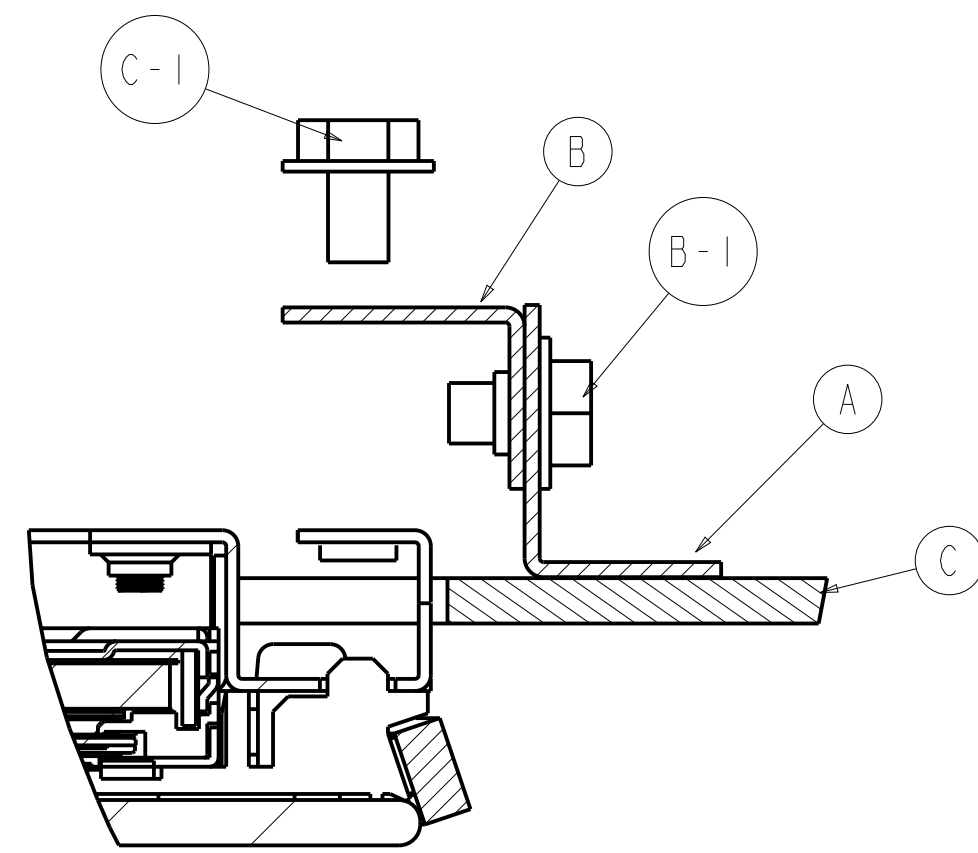

SECTION V-V
SCALE 2.000

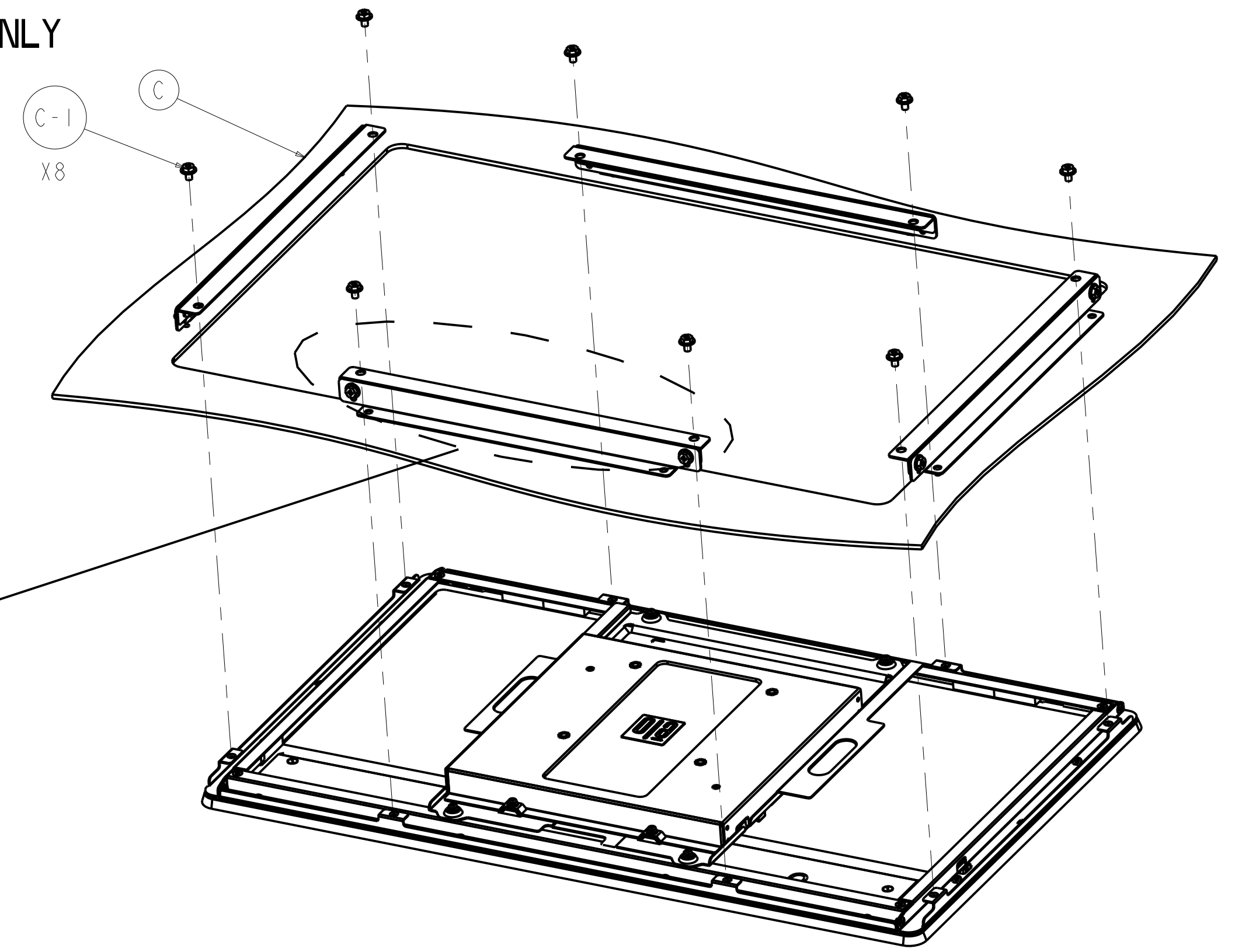
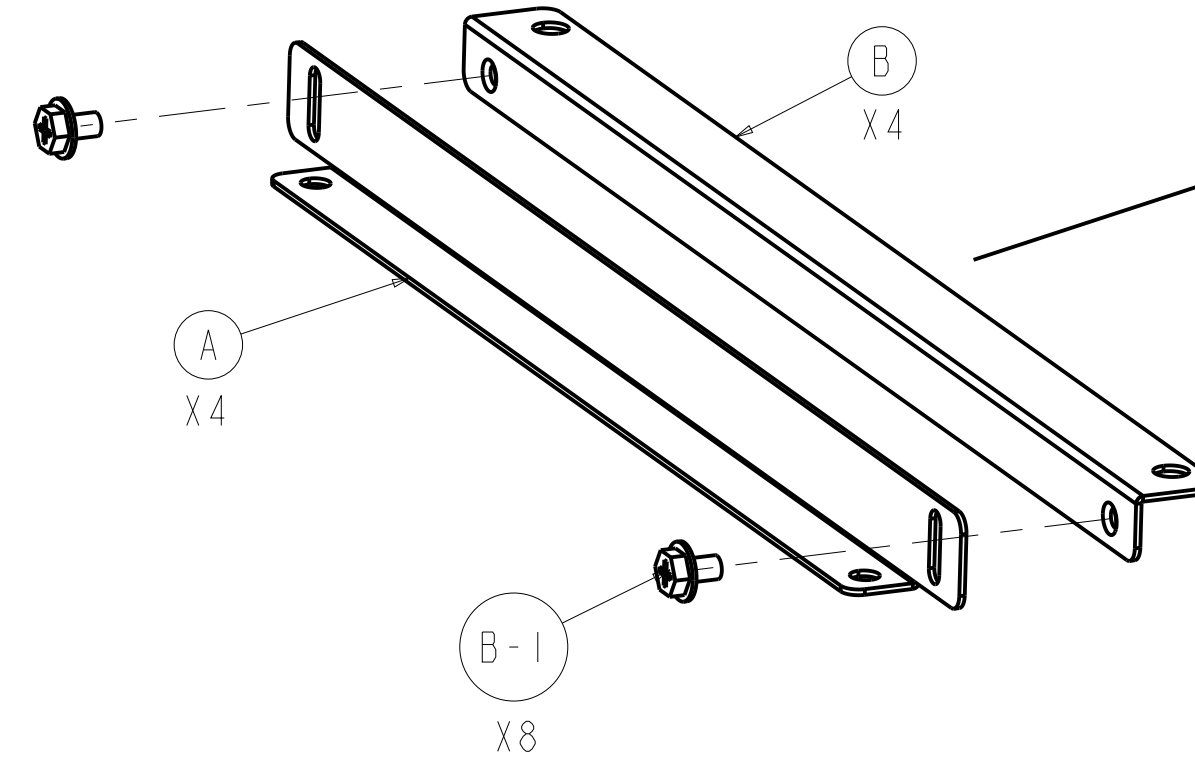
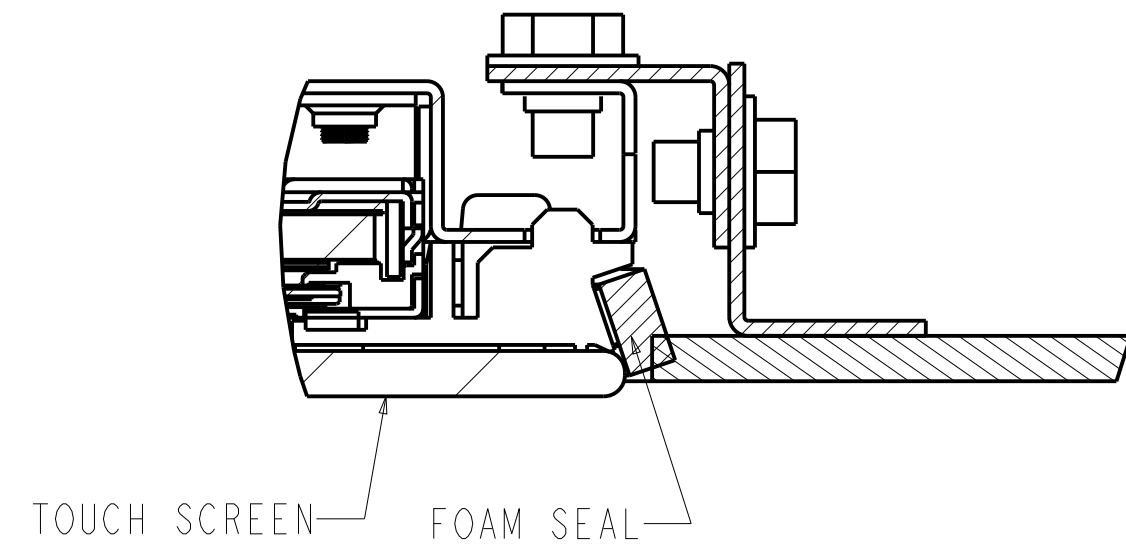

CUSTOMER PANEL CUT-OUT

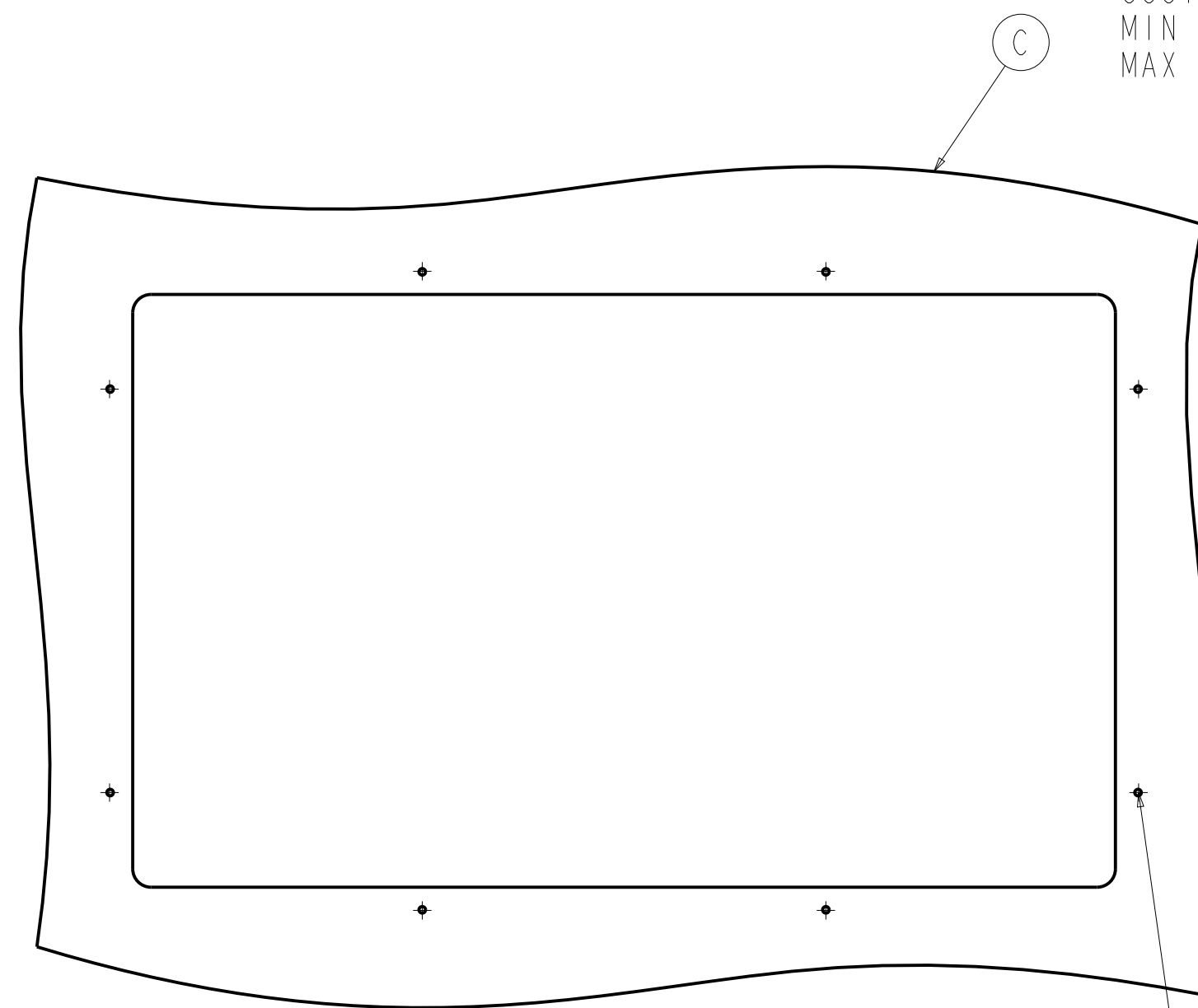

CUSTOMER PANEL:
MIN THICKNESS = 3mm
MAX THICKNESS = 8.5mm

MOUNTING HOLES, X8
IF CUSTOMER PANEL IS METAL,
BLIND HOLE, M4 THREADS

